

COORDINATE TABLE					
NO.	NORTH	EAST	NO.	NORTH	EAST
1	12173.30	10242.33	34	10242.33	11533.24
2	12173.30	10242.33	35	10242.33	11533.24
3	10242.33	10242.33	36	10242.33	11533.24
4	10242.33	10242.33	37	10242.33	11533.24
5	10242.33	10242.33	38	10242.33	11533.24
6	10242.33	10242.33	39	10242.33	11533.24
7	10242.33	10242.33	40	10242.33	11533.24
8	10242.33	10242.33	41	10242.33	11533.24
9	10242.33	10242.33	42	10242.33	11533.24
10	10242.33	10242.33	43	10242.33	11533.24
11	10242.33	10242.33	44	10242.33	11533.24
12	10242.33	10242.33	45	10242.33	11533.24
13	10242.33	10242.33	46	10242.33	11533.24
14	10242.33	10242.33	47	10242.33	11533.24
15	10242.33	10242.33	48	10242.33	11533.24
16	10242.33	10242.33	49	10242.33	11533.24
17	10242.33	10242.33	50	10242.33	11533.24
18	10242.33	10242.33	51	10242.33	11533.24
19	10242.33	10242.33	52	10242.33	11533.24
20	10242.33	10242.33	53	10242.33	11533.24
21	10242.33	10242.33	54	10242.33	11533.24
22	10242.33	10242.33	55	10242.33	11533.24
23	10242.33	10242.33	56	10242.33	11533.24
24	10242.33	10242.33	57	10242.33	11533.24
25	10242.33	10242.33	58	10242.33	11533.24
26	10242.33	10242.33	59	10242.33	11533.24
27	10242.33	10242.33	60	10242.33	11533.24
28	10242.33	10242.33	61	10242.33	11533.24
29	10242.33	10242.33	62	10242.33	11533.24
30	10242.33	10242.33	63	10242.33	11533.24
31	10242.33	10242.33	64	10242.33	11533.24
32	10242.33	10242.33	65	10242.33	11533.24
33	10242.33	10242.33	66	10242.33	11533.24
34	10242.33	10242.33	67	10242.33	11533.24
35	10242.33	10242.33	68	10242.33	11533.24
36	10242.33	10242.33	69	10242.33	11533.24
37	10242.33	10242.33	70	10242.33	11533.24

CURVE DATA						
NO.	RADIUS	Δ	ARC	TAN.	CH. BEAR.	CHORD
1	25.00	25.00	25.00	25.00	25.00	25.00
2	25.00	25.00	25.00	25.00	25.00	25.00
3	25.00	25.00	25.00	25.00	25.00	25.00
4	25.00	25.00	25.00	25.00	25.00	25.00
5	25.00	25.00	25.00	25.00	25.00	25.00
6	25.00	25.00	25.00	25.00	25.00	25.00
7	25.00	25.00	25.00	25.00	25.00	25.00
8	25.00	25.00	25.00	25.00	25.00	25.00
9	25.00	25.00	25.00	25.00	25.00	25.00
10	25.00	25.00	25.00	25.00	25.00	25.00
11	25.00	25.00	25.00	25.00	25.00	25.00
12	25.00	25.00	25.00	25.00	25.00	25.00
13	25.00	25.00	25.00	25.00	25.00	25.00
14	25.00	25.00	25.00	25.00	25.00	25.00
15	25.00	25.00	25.00	25.00	25.00	25.00
16	25.00	25.00	25.00	25.00	25.00	25.00
17	25.00	25.00	25.00	25.00	25.00	25.00
18	25.00	25.00	25.00	25.00	25.00	25.00
19	25.00	25.00	25.00	25.00	25.00	25.00
20	25.00	25.00	25.00	25.00	25.00	25.00
21	25.00	25.00	25.00	25.00	25.00	25.00
22	25.00	25.00	25.00	25.00	25.00	25.00
23	25.00	25.00	25.00	25.00	25.00	25.00
24	25.00	25.00	25.00	25.00	25.00	25.00
25	25.00	25.00	25.00	25.00	25.00	25.00
26	25.00	25.00	25.00	25.00	25.00	25.00
27	25.00	25.00	25.00	25.00	25.00	25.00
28	25.00	25.00	25.00	25.00	25.00	25.00
29	25.00	25.00	25.00	25.00	25.00	25.00
30	25.00	25.00	25.00	25.00	25.00	25.00
31	25.00	25.00	25.00	25.00	25.00	25.00
32	25.00	25.00	25.00	25.00	25.00	25.00
33	25.00	25.00	25.00	25.00	25.00	25.00
34	25.00	25.00	25.00	25.00	25.00	25.00
35	25.00	25.00	25.00	25.00	25.00	25.00
36	25.00	25.00	25.00	25.00	25.00	25.00
37	25.00	25.00	25.00	25.00	25.00	25.00
38	25.00	25.00	25.00	25.00	25.00	25.00
39	25.00	25.00	25.00	25.00	25.00	25.00
40	25.00	25.00	25.00	25.00	25.00	25.00
41	25.00	25.00	25.00	25.00	25.00	25.00
42	25.00	25.00	25.00	25.00	25.00	25.00
43	25.00	25.00	25.00	25.00	25.00	25.00
44	25.00	25.00	25.00	25.00	25.00	25.00
45	25.00	25.00	25.00	25.00	25.00	25.00
46	25.00	25.00	25.00	25.00	25.00	25.00
47	25.00	25.00	25.00	25.00	25.00	25.00
48	25.00	25.00	25.00	25.00	25.00	25.00
49	25.00	25.00	25.00	25.00	25.00	25.00
50	25.00	25.00	25.00	25.00	25.00	25.00
51	25.00	25.00	25.00	25.00	25.00	25.00
52	25.00	25.00	25.00	25.00	25.00	25.00
53	25.00	25.00	25.00	25.00	25.00	25.00
54	25.00	25.00	25.00	25.00	25.00	25.00
55	25.00	25.00	25.00	25.00	25.00	25.00
56	25.00	25.00	25.00	25.00	25.00	25.00
57	25.00	25.00	25.00	25.00	25.00	25.00
58	25.00	25.00	25.00	25.00	25.00	25.00
59	25.00	25.00	25.00	25.00	25.00	25.00
60	25.00	25.00	25.00	25.00	25.00	25.00
61	25.00	25.00	25.00	25.00	25.00	25.00
62	25.00	25.00	25.00	25.00	25.00	25.00
63	25.00	25.00	25.00	25.00	25.00	25.00
64	25.00	25.00	25.00	25.00	25.00	25.00
65	25.00	25.00	25.00	25.00	25.00	25.00
66	25.00	25.00	25.00	25.00	25.00	25.00
67	25.00	25.00	25.00	25.00	25.00	25.00
68	25.00	25.00	25.00	25.00	25.00	25.00
69	25.00	25.00	25.00	25.00	25.00	25.00
70	25.00	25.00	25.00	25.00	25.00	25.00
71	25.00	25.00	25.00	25.00	25.00	25.00
72	25.00	25.00	25.00	25.00	25.00	25.00
73	25.00	25.00	25.00	25.00	25.00	25.00
74	25.00	25.00	25.00	25.00	25.00	25.00

**GENERAL NOTES:**

- The origin of all coordinates shown herein is assumed.
- All road right of ways 50' wide except as otherwise noted.
- Iron bars have been placed at all P.C.'s, P.T.'s and as shown thus: 

CHESAPEAKE BAY

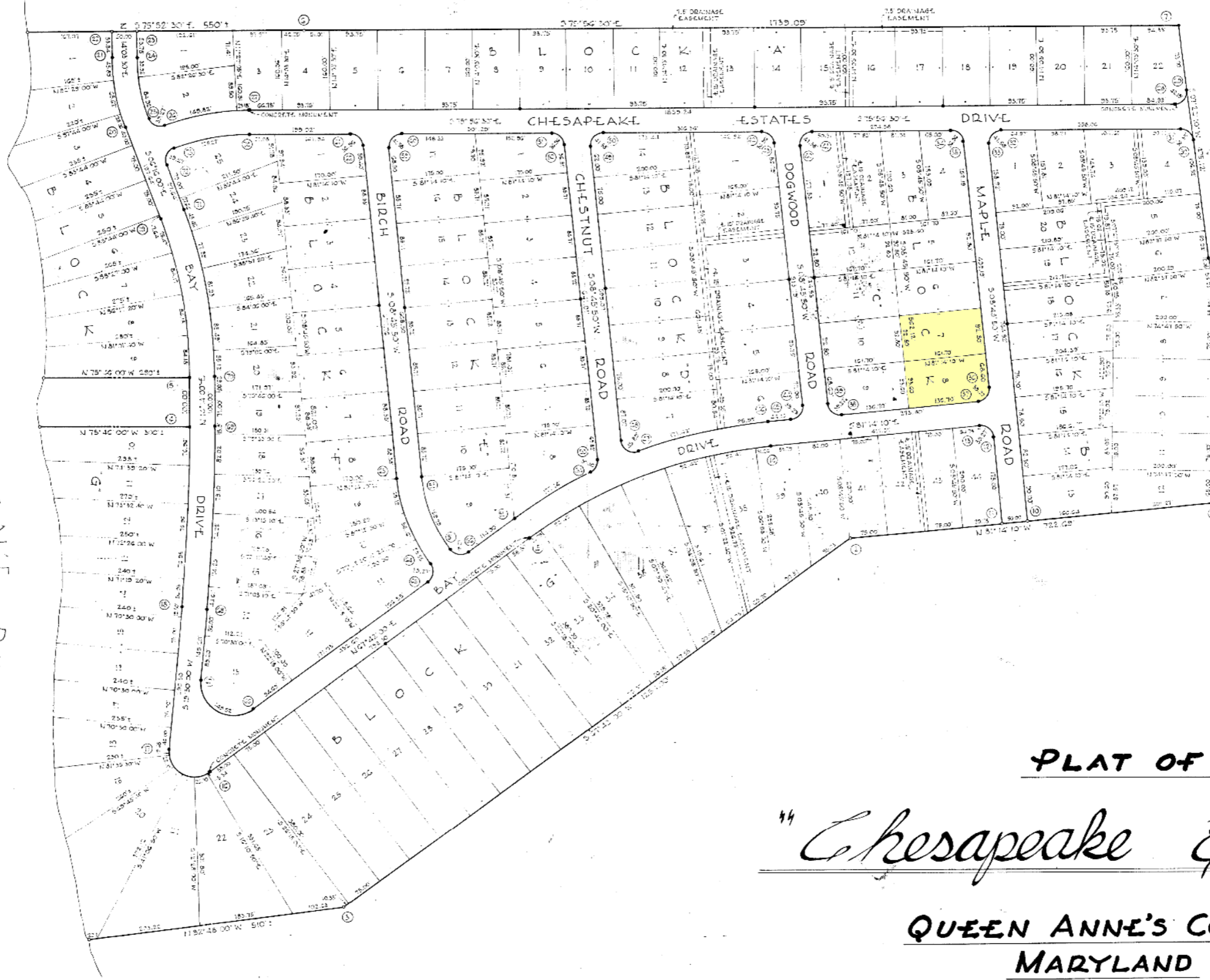

MADLAND ROUTE NO. 33

APPROVED  
DATE *March 17, 1960*  
COUNTY COMMISSIONERS  
OF QUEEN ANNE'S COUNTY, MARYLAND  
*Thomas C. Lyggett*  
CLERK

PLAT OF  
*Chesapeake Estates*

QUEEN ANNE'S COUNTY  
MARYLAND

FEBRUARY 19, 1960

SCALE: 1"=100'

**OWNER'S CERTIFICATE:**  
The requirements of Sections 72A, 72B, and 72C of article 11 of the Annotated Code of Maryland, 1956 Edition (Title: Clerks of Courts; sub-Title: Clerks of Circuit Courts) as far as they relate to the making of this plat and the setting of markers has been complied with. Also, Section 1732 of Article 118B of Code of Public Laws of Maryland (entitled: Queen Anne County; sub-Title: Plats) GUARANTEED REALTY CORPORATION, OWNED  
*David M. Nichols* - February 19, 1960  
President DAVID M. NICHOLS

**SURVEYOR'S CERTIFICATE:**  
I, Curt A.M. Lochke, a registered Professional Engineer and Land Surveyor of the State of Maryland, do hereby certify that the land shown herein has been laid out and the plat shown prepared in accordance with the provisions of the law relating to the subdivision of land (known as House Bill 453, Chapter 1016 of the Acts of 1945 and subsequent Acts amendatory thereto and also Section 1732 of Article 118B of the Code of Public Local Laws of Maryland (entitled: Queen Anne County; sub-Title: Plats).  
*Curt A.M. Lochke* - February 19, 1960  
CURT A.M. LOCHKE REG. NO. 2351

Approved  
3-17-60  
*James K. Martin*  
San. Ins. Div.  
Queen Anne County  
Health Dept.



MURDOCK & JOCHKE