

CONDO. PLAT No. 9719

RECEIVED FOR TRANSFER
 to the Department of Assessments & Taxation
 for the purpose of recording
 this document
 HHS

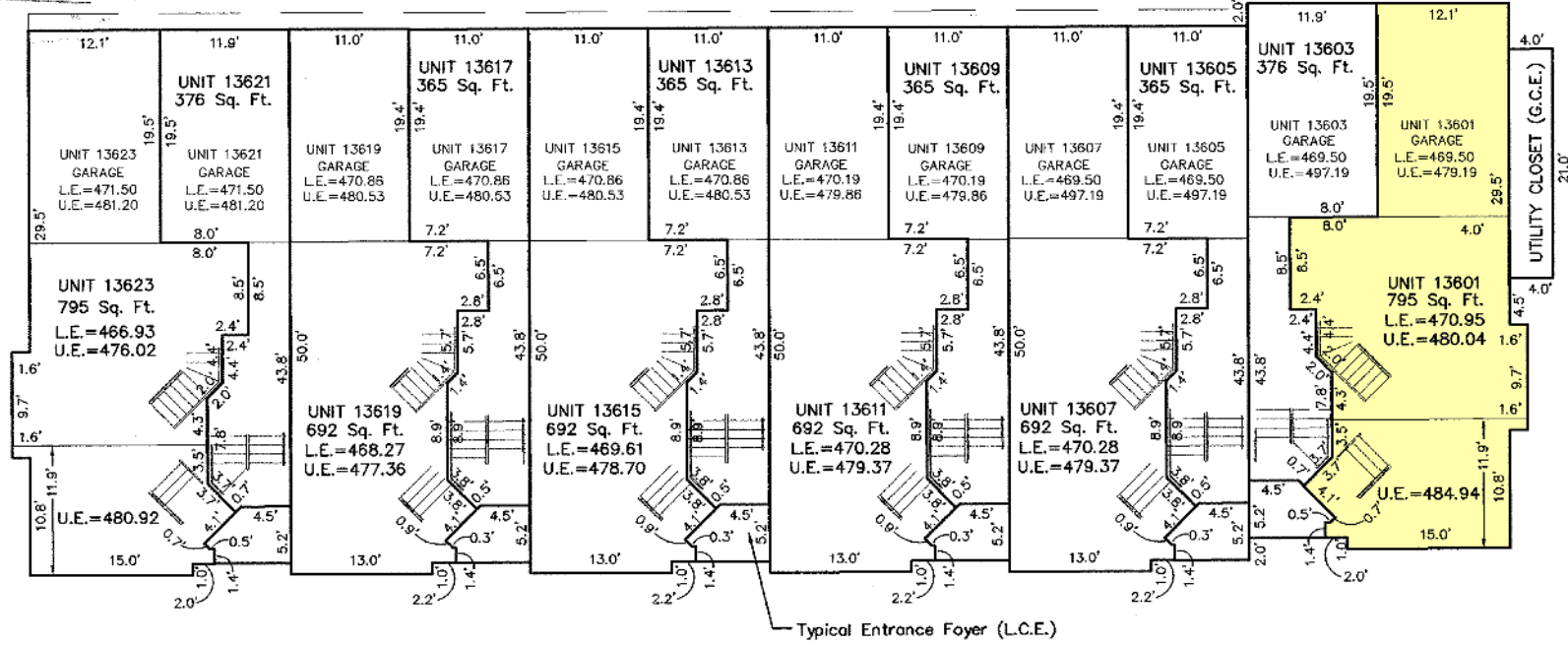

- GENERAL NOTES**
- Vertical Datum based on the Washington Suburban Sanitary Commission.
 - Each Unit shown hereon is designated by a 5-digit number which corresponds to the building address. Example #13601.
 - All dimensions are in feet.
 - Unit areas are computed in square footage and designated hereon as Sq. Ft.
 - General Common Elements (G.C.E.) include all areas of the property within Condominium I except for the Units and the Limited Common Elements, including those areas designated as G.C.E. on this plat, and those areas more specifically defined as General Common Elements in Section 3.1 of the Declaration.
 - Limited Common Elements (L.C.E.) include those areas designated as L.C.E. on this condominium plat, in the Declaration (including Section 3.2 of the Declaration) and as may be set forth in any supplementary declaration.
 - Each Unit is as shown on this condominium plat and as further defined in Section 1.19 of the Declaration.
 - As shown on this condominium plat, Phase Three of Condominium I contains 12 Units.
 - Each Unit is accessed by an entrance foyer that is used in common with an adjacent Unit. Each such entrance foyer is a Limited Common Element appurtenant to the two Units for which it provides access.

FIRST FLOOR PLAN

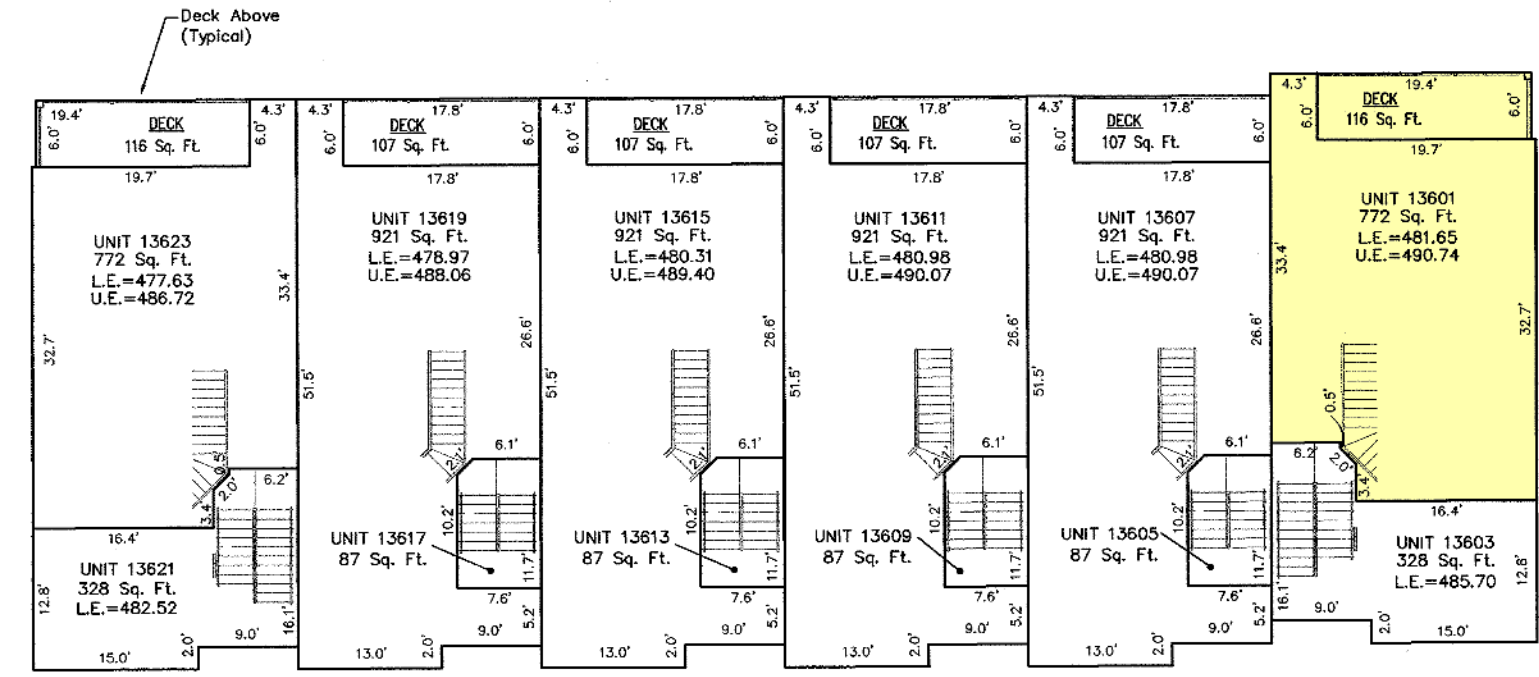

SECOND FLOOR PLAN

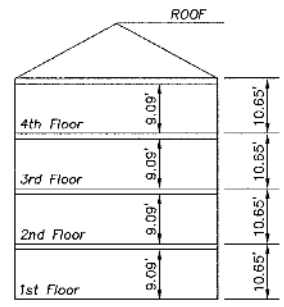

TYPICAL BUILDING DIMENSIONS
 Not To Scale

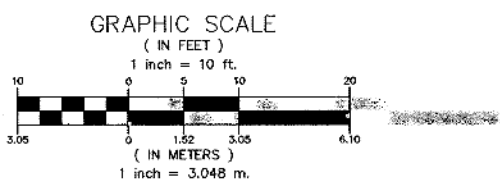

LEGEND

- L.E. = LOWER ELEVATION
- U.E. = UPPER ELEVATION
- L.C.E. = LIMITED COMMON ELEMENT
- G.C.E. = GENERAL COMMON ELEMENT

RECEIVED
 AUG 31 2007
 Clerk of the Circuit Court
 Montgomery County, Md.

MHG Macris, Hendricks & Glascock, P.A.
 Engineers • Planners
 Landscape Architects • Surveyors
 9220 Wightman Road, Suite 120
 Montgomery Village, Maryland
 20886-1279
 Phone 301.670.0840
 Fax 301.948.0693
 www.mhga.com

CONDOMINIUM PLAT
 SHEET 3 OF 5
 LAND UNIT 17
BUCKINGHAM STATION
CONDOMINIUM I
PHASE THREE
 ELECTION DISTRICT No. 2
 MONTGOMERY COUNTY, MARYLAND
 SCALE: 1" = 10' AUGUST, 2007

DATE: _____
 Condominium Plat No.:

1
 2
 3
 4
 5
 6
 Maryland State Archives

HSA SSu 1264 7276-3

P142496

MONTGOMERY COUNTY, MD PLAT 9719, SHEET 3 OF 5, BUCKINGHAM STATION CONDOMINIUM I, PHASE THREE, ELECTION DISTRICT NO. 2, AUGUST 2007. Date available 2007/07/31. Printed 04/09/2026.