

# REVISIONS

Block Revised Per App. & D.P.C. Sh. 1886  
 Lots 12 to 46 Per P.S. & App. C. Sh. 2017/18 VOID  
 Lots 12 to 13 Per Deed 6024-230 C. Sh. 2018 VOID  
 Lots 1/11, 12/33, 46, & 39 to 45 Per B. of A. & App. 4920/33 C. Sh. 2168  
 Lot 12/36 Divided Per App. & P.S. C. Sh. 2201  
 Lot 1/11 Divided Per App. 6910/27, C. Sh. 2472.  
 Lots 46-81 per App. 138/173 C. Sh. 2627-28  
 Section Changed Per D of A, C. Sh. 5705A.  
 Lots 18, 46, 51, 58, & 63 COR. PER DEEDS; C. Sh. 89-404.

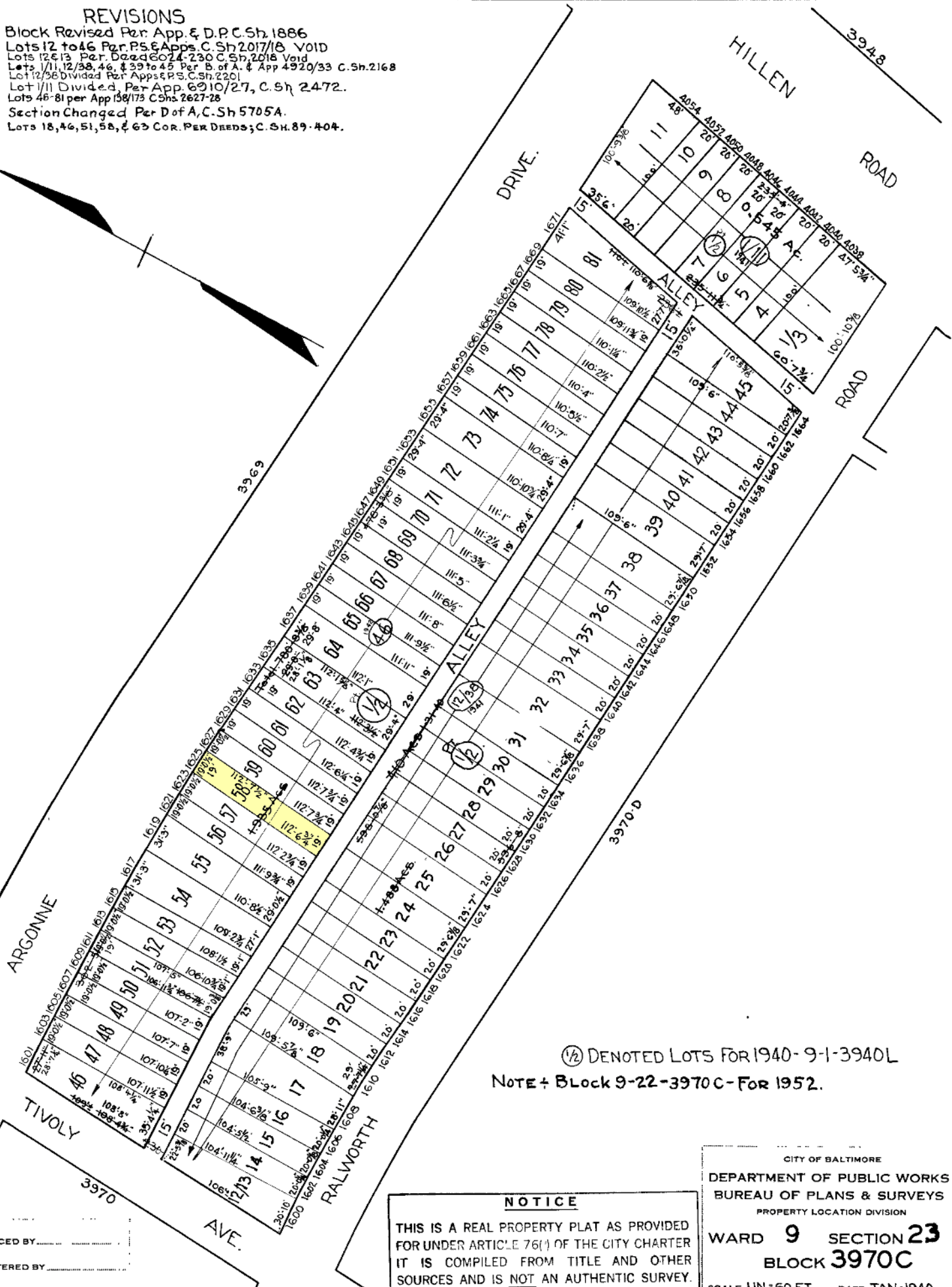
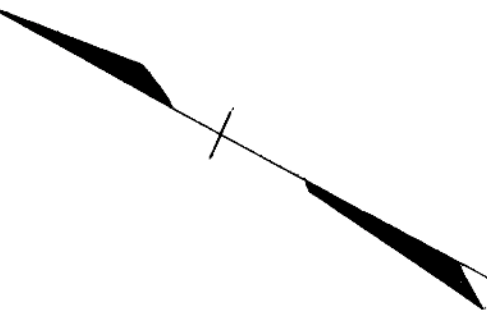

1/2 DENOTED LOTS FOR 1940-9-1-3940L  
 NOTE - Block 9-22-3970C - For 1952.

## NOTICE

THIS IS A REAL PROPERTY PLAT AS PROVIDED  
 FOR UNDER ARTICLE 76(1) OF THE CITY CHARTER  
 IT IS COMPILED FROM TITLE AND OTHER  
 SOURCES AND IS NOT AN AUTHENTIC SURVEY.

CITY OF BALTIMORE  
 DEPARTMENT OF PUBLIC WORKS  
 BUREAU OF PLANS & SURVEYS  
 PROPERTY LOCATION DIVISION

WARD 9 SECTION 23  
 BLOCK 3970C

SCALE 1 IN. = 60 FT. DATE JAN. 1940

TRACED BY \_\_\_\_\_  
 LETTERED BY \_\_\_\_\_  
 CHECKED BY \_\_\_\_\_