

# REVISIONS

LOTS 2-3A, G-9, 18/20 PER DEED, SUB-DIV. APP'LS, CSH 87-130-131  
 LOTS 6&8 PER DEED & SUB-DIV. CSH 87-142  
 LOT 2 DIV PER DEED & D.P. CSH 85-205

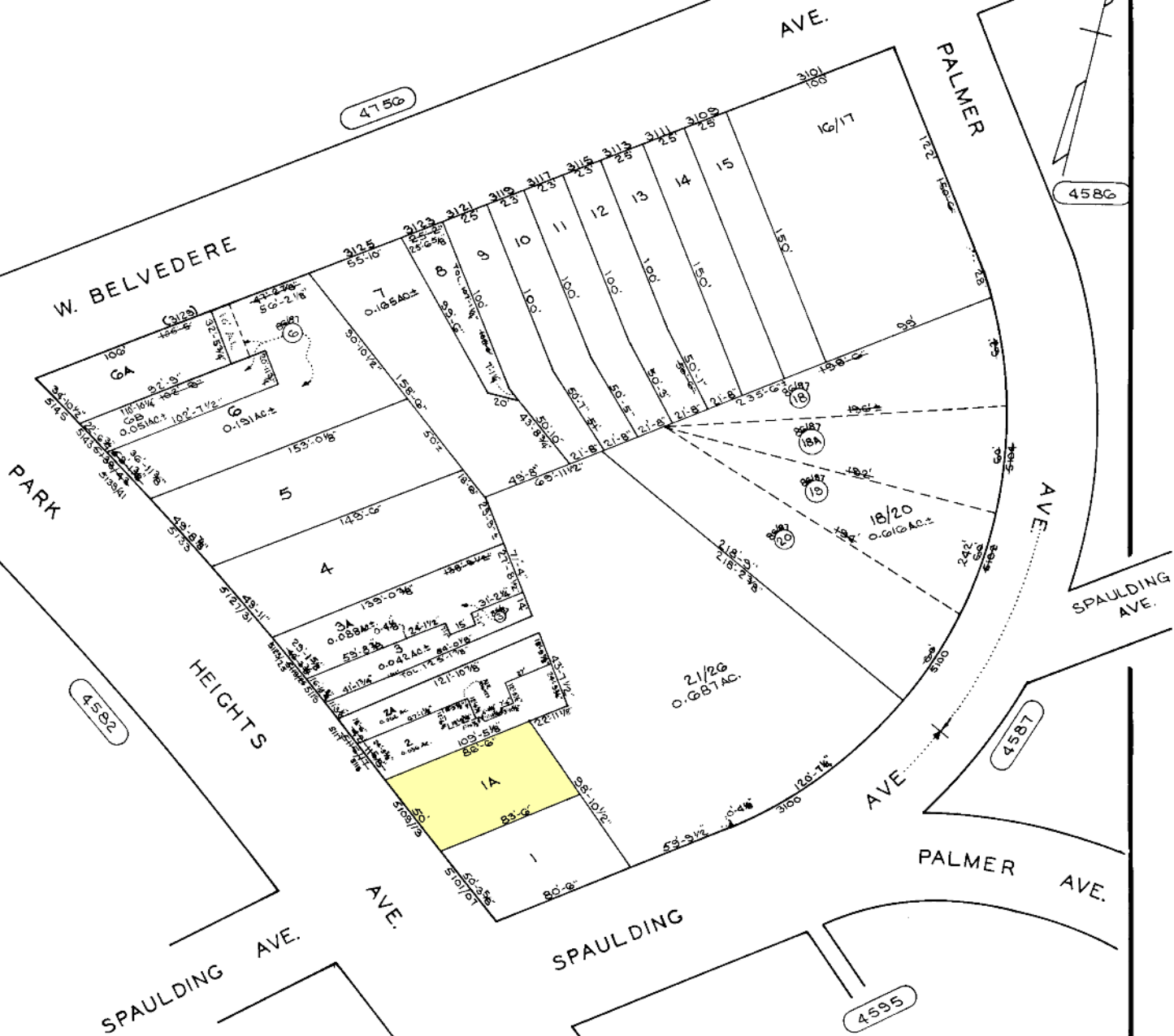

LOT 2A  
 0.057 Ac.  
 0.006 " Air. RIGHTS  
 0.062 " Res. 12-6-86

TRACED BY D.G.  
 LETTERED BY D.G.  
 CHECKED BY

## NOTICE

THIS IS A REAL PROPERTY PLAT AS PROVIDED  
 FOR UNDER ARTICLE 76(d) OF THE CITY CHARTER  
 IT IS COMPILED FROM TITLE AND OTHER  
 SOURCES AND IS NOT AN AUTHENTIC SURVEY.

CITY OF BALTIMORE  
 DEPARTMENT OF PUBLIC WORKS

PROPERTY LOCATION DIVISION

WARD 27 SECTION 19

BLOCK 4584

SCALE 1"=50' DATE OCT 1986