

NORTH LOVEGROVE STREET

EAST PRESTON STREET

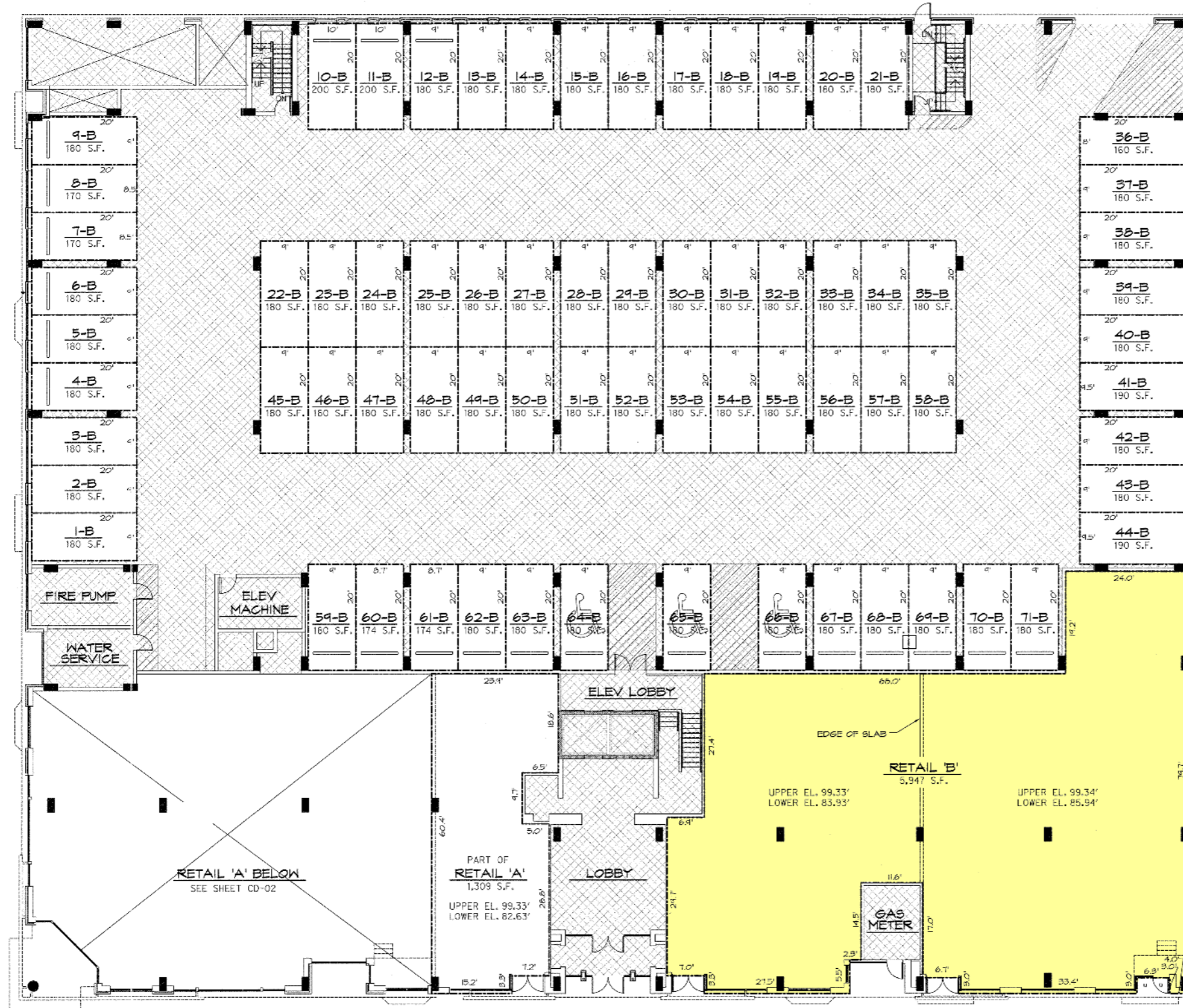

NORTH CHARLES STREET

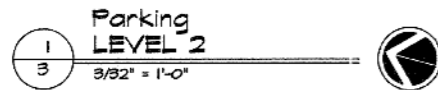

SEP 28 2007
 Rec'd for record & recorded in the Plat Records of Baltimore City
 Plat Record F.M.G. No. 705
 Land Record Reference (if any)
 Liber F.M.G. No. Folio
 Frank M. Conway, Clerk
 Blocks 484
 9:50 AM
 P46-799

FLOOR PLAN LEGEND

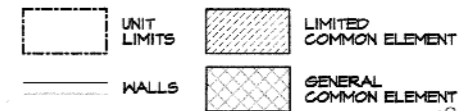

Revisions		
No.	Description	Date

THIS IS TO CERTIFY THAT I HAVE MEASURED THE CONDOMINIUM UNITS AND THE DIMENSIONS OF THE SAME ARE AS SHOWN ON THE PLAT



Certification

THE 1209 NORTH CHARLES CONDOMINIUM
 1209 North Charles Street
 Baltimore, Maryland 21201

STV Incorporated
 Architects • Planners • Engineers

7725 Ambassador Road
 Suite 200
 Baltimore, Maryland 21244
 410.966.9112 410.298.2794 fax

Sheet Title

PARKING LEVEL TWO

Scale: AS NOTED
 Date: September 4, 2007
 Drawn By: D.J.L./A.J.C.
 Designed By: -
 Checked By: P.S.E.
 Job Number: 03-12125
 Sheet:

CD-03

3 of 10

MSA Cm 2886 294-3