

REVISIONS

LOTS 52 TO 59 CONS'D PER APP. 1444 C.S.H. 2301
 Lots 52/59 & 60 CONS'D PER A.; c.s.h. 9385
 LOT 52/60, HO. NO. C.H. PER PLS; c.s.h. 307A.

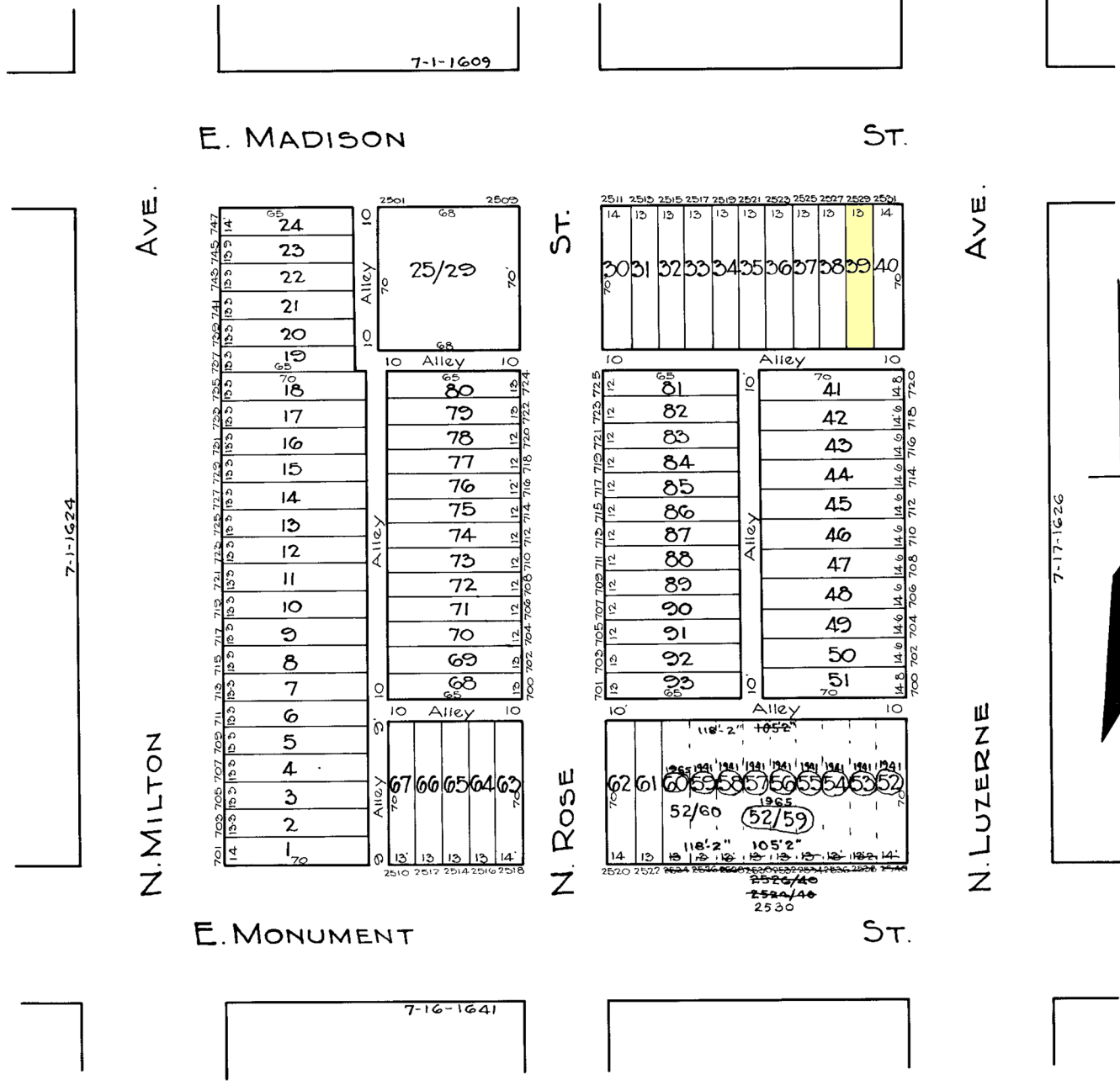

6 BAUERSFELD
 TRACED BY C. GILBERT
 LETTERED BY W. M. Lee
 CHECKED BY W. M. Lee
 R. LITZ - BAIN

NOTICE
 THIS IS A REAL PROPERTY PLAT AS PROVIDED
 FOR UNDER ARTICLE 73(b) OF THE CITY CHARTER
 IT IS COMPILED FROM TITLE AND OTHER
 SOURCES AND IS NOT AN AUTHENTIC SURVEY

CITY OF BALTIMORE
 DEPARTMENT OF PUBLIC WORKS
 BUREAU OF PLANS & SURVEYS
 PROPERTY LOCATION DIVISION
WARD 7 SECTION 17
BLOCK 1625
 SCALE 1" = 50'-0" DATE April 1929