

**REVISIONS**

BLOCK REVISED PER P.L.S. C.S.H. 71-76

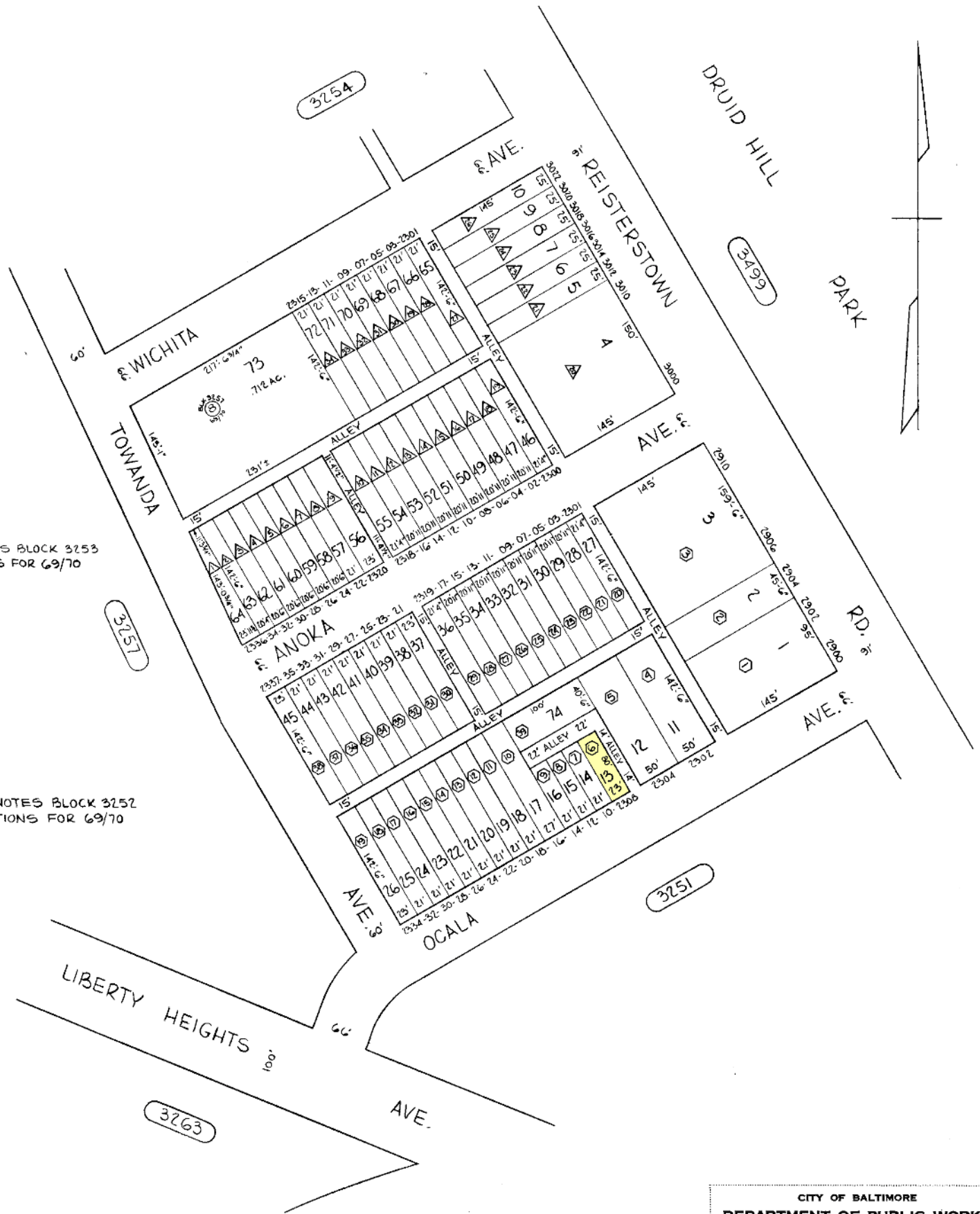

△ DENOTES BLOCK 3253  
CONDITIONS FOR 69/70

⬡ DENOTES BLOCK 3252  
CONDITIONS FOR 69/70

TRACED BY DON R. GRIFFIN  
LETTERED BY DON R. GRIFFIN  
CHECKED BY \_\_\_\_\_

**NOTICE**  
THIS IS A REAL PROPERTY PLAT AS PROVIDED FOR UNDER ARTICLE 76(d) OF THE CITY CHARTER IT IS COMPILED FROM TITLE AND OTHER SOURCES AND IS NOT AN AUTHENTIC SURVEY.

CITY OF BALTIMORE  
DEPARTMENT OF PUBLIC WORKS  
PROPERTY LOCATION DIVISION  
WARD 15 SECTION 30  
BLOCK 3252  
SCALE 1" = 100' DATE OCT. 1969