

REVISIONS
 Dim. Lot, 25/26 per Deed, Field. C.Sh. 1414.
 Lots 49 to 52 Cons'd PER APP 3043 C.S.H. 2026
 SECTION CHANGED PER P.S. C.S.H. 3143.
 LOT 45 HO. NO. CHANGED PER APP. C.S.H. 80-010

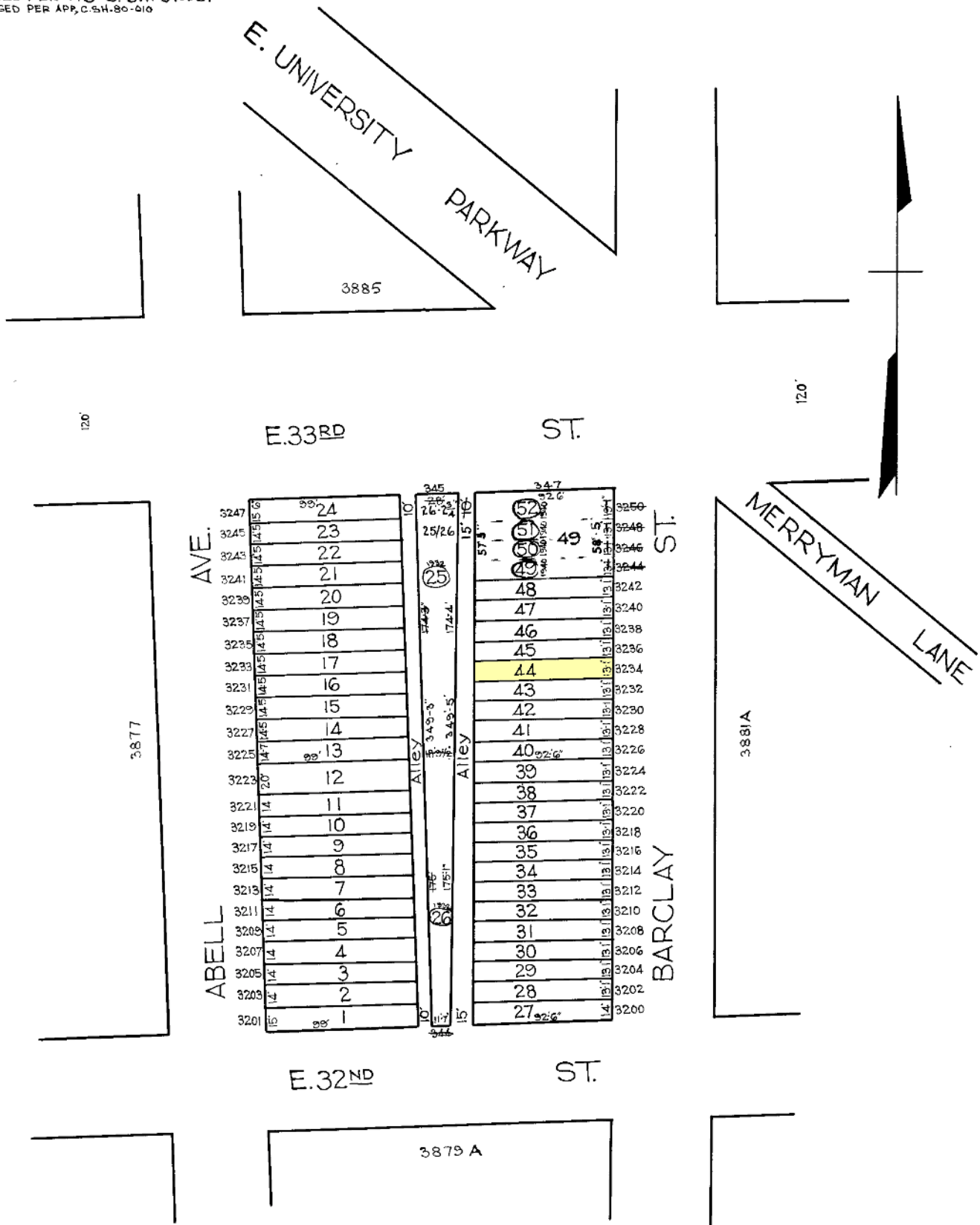

NOTE: BLOCK 12-1-3879-B FOR 1944

TRACED BY *M. Stumpf*
 LETTERED BY J.J.R.
 CHECKED BY _____

NOTICE
 THIS IS A REAL PROPERTY PLAT AS PROVIDED
 FOR UNDER ARTICLE 75(1) OF THE CITY CHARTER.
 IT IS COMPILED FROM TITLE AND OTHER
 RECORDS AND IS NOT AN AUTHENTIC SURVEY

CITY OF BALTIMORE
 DEPARTMENT OF PUBLIC WORKS
 BUREAU OF PLANS & SURVEYS
 PROPERTY LOCATION DIVISION
 WARD 12 SECTION 20
 BLOCK 3879 - B
 SCALE 1/4" = 60 FT. DATE May 1930