

REVISIONS

BLK. RD'WN PER P.L.S. NO C.S.H.
 LOT 85 COR. PER DEED P.L.S.; C.S.H. 90-321.
 LOTS 65, 77, & 101 COR. PER P.L.S.; C.S.H. 90-321.

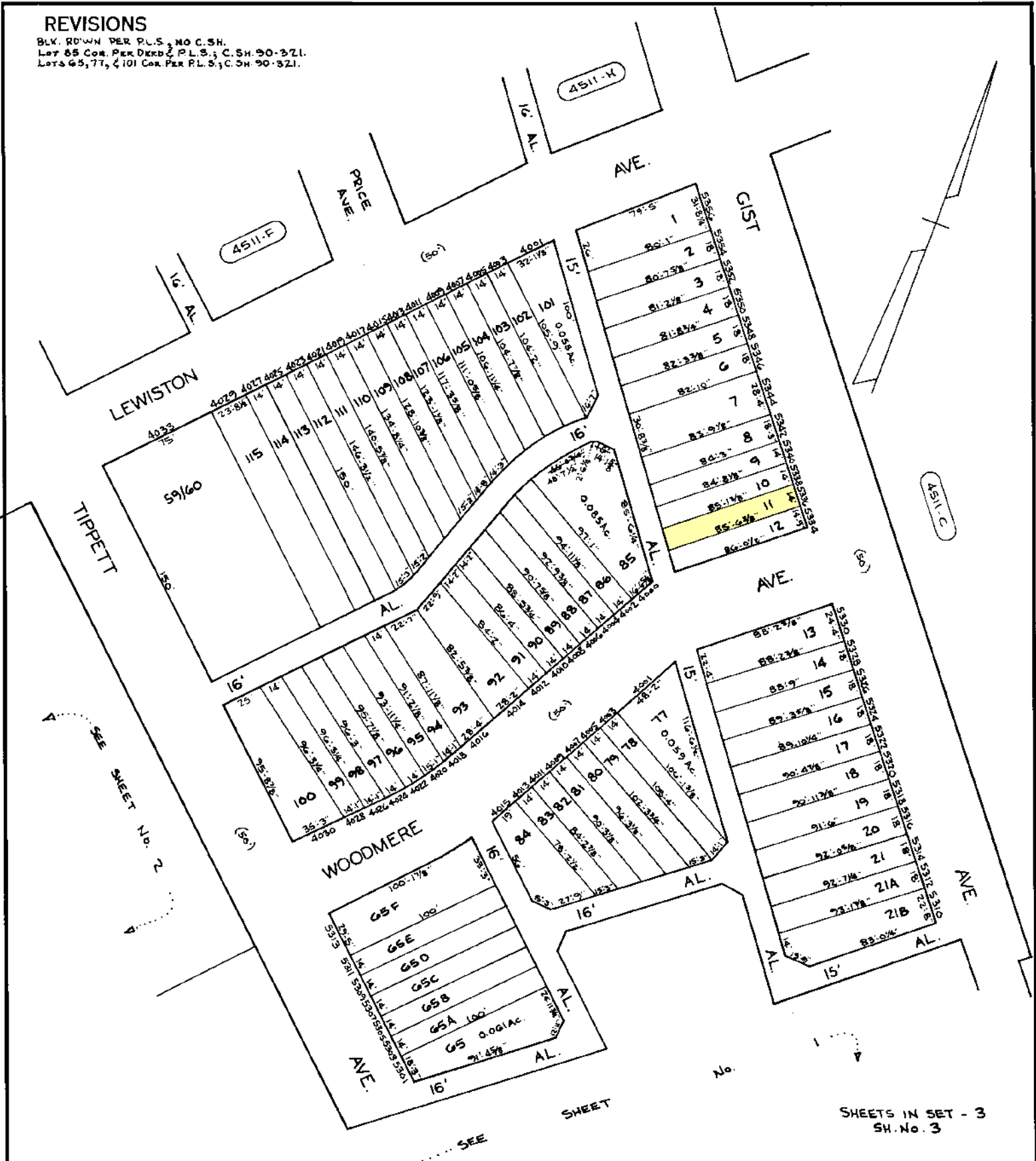

TRACED BY: *R. P. Beatty*
 LETTERED BY: *R. P. Beatty*
 CHECKED BY: _____

NOTICE
 THIS IS A REAL PROPERTY PLAT AS PROVIDED FOR UNDER ARTICLE 76(d) OF THE CITY CHARTER IT IS COMPILED FROM TITLE AND OTHER SOURCES AND IS NOT AN AUTHENTIC SURVEY.

CITY OF BALTIMORE
 DEPARTMENT OF PUBLIC WORKS
 PROPERTY LOCATION DIVISION
 WARD **27** SECTION **21**
 BLOCK **4511-D**
 SCALE: 1" = 50' DATE: **MARCH 1987**