

REVISIONS.

Lot 48, Dim. Corr. Per Survey, C. Sh. 2274-A
 Lots 1 & 2 Per Deed, C. Sh. 8884
 Lot 47, No. Per App. C. Sh. 9126-A
 Lots 1 & 2 Per O.O., C. Sh. 839
 Lots 1-13 Dim Corr Per Deed C Sh 79-127

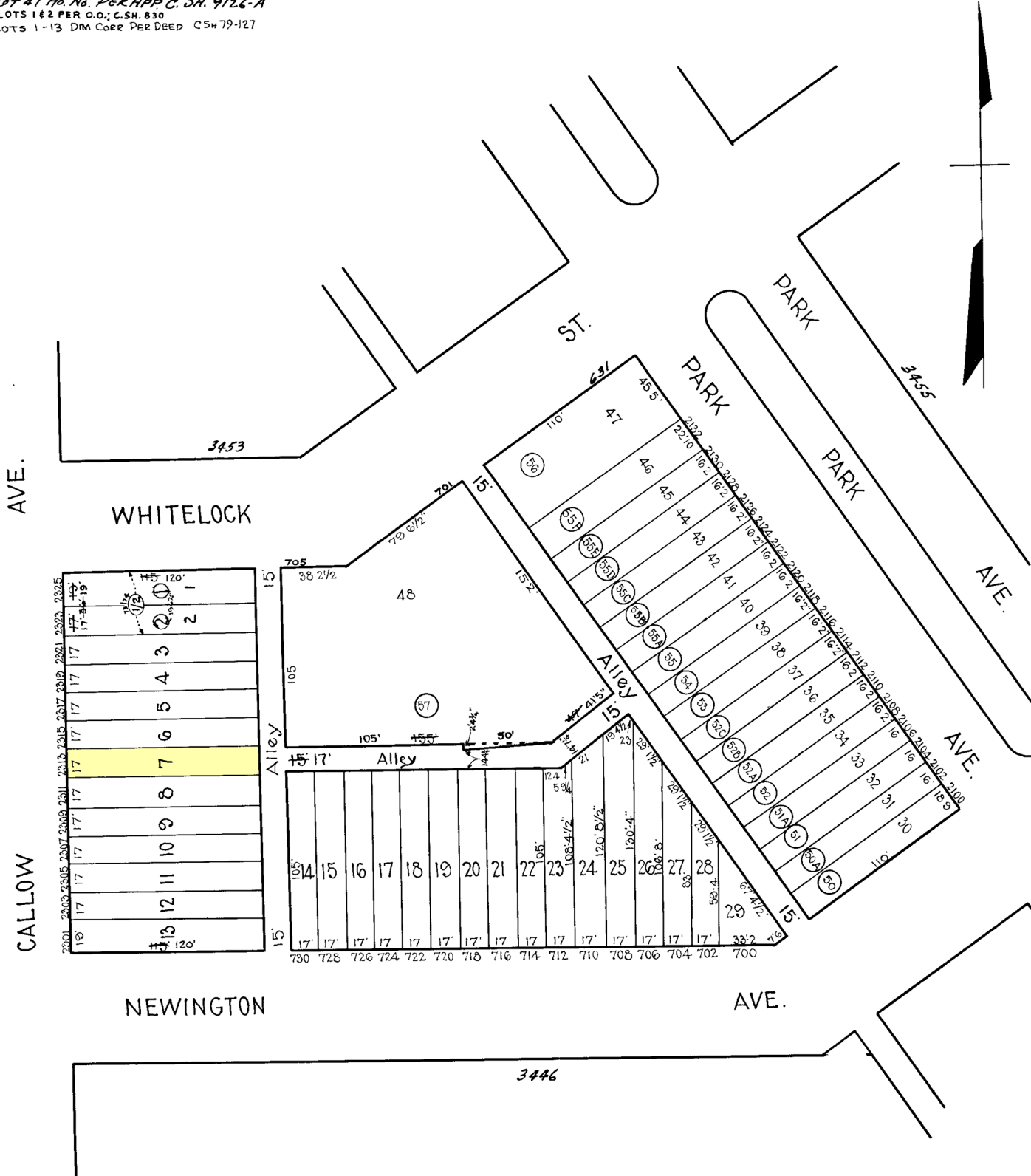

2301	2302	2303	2304	2305	2306	2307	2308	2309	2310	2311	2312	2313	2314	2315	2316	2317	2318	2319	2320	2321	2322	2323	2324	2325
13	14	15	16	17	17	17	17	17	17	17	17	17	17	17	17	17	17	17	17	17	17	17	17	17
12	11	10	9	8	7	6	5	4	3	2	1													

Note: (57) Denotes Lot Numbers for 1930
 in Block # 3454-3455.

TRACED BY: C. H. BAIN
 LETTERED BY: W M Lee
 CHECKED BY:

NOTICE
 THIS IS A REAL PROPERTY PLAT AS PROVIDED
 FOR UNDER ARTICLE 76(d) OF THE CITY CHARTER
 IT IS COMPILED FROM TITLE AND OTHER
 SOURCES AND IS NOT AN AUTHENTIC SURVEY

CITY OF BALTIMORE
 DEPARTMENT OF PUBLIC WORKS
 BUREAU OF PLANS & SURVEYS
 PROPERTY LOCATION DIVISION
WARD 13 SECTION 11
BLOCK 3454
 SCALE: 1" = 50' 0" DATE Dec 1929