

REVISIONS

Lots 12 to 15 consid per App C. Sh. 3529
 Pt Lot 25 to 26 Per Q.D. Letter C. Sh. 5575 B
 Lots 1 to 12/15 Desc Per PL D. C. Sh. 9448 C
 Lots 25 & 26 Per Deeds, C. Sh. 85-358
 Lots 4-7/8, 10-10B, 30-41, 43-53, & 54A-57 DIM CHANGED PER DEEDS
 C. Sh. 27-434 - 436

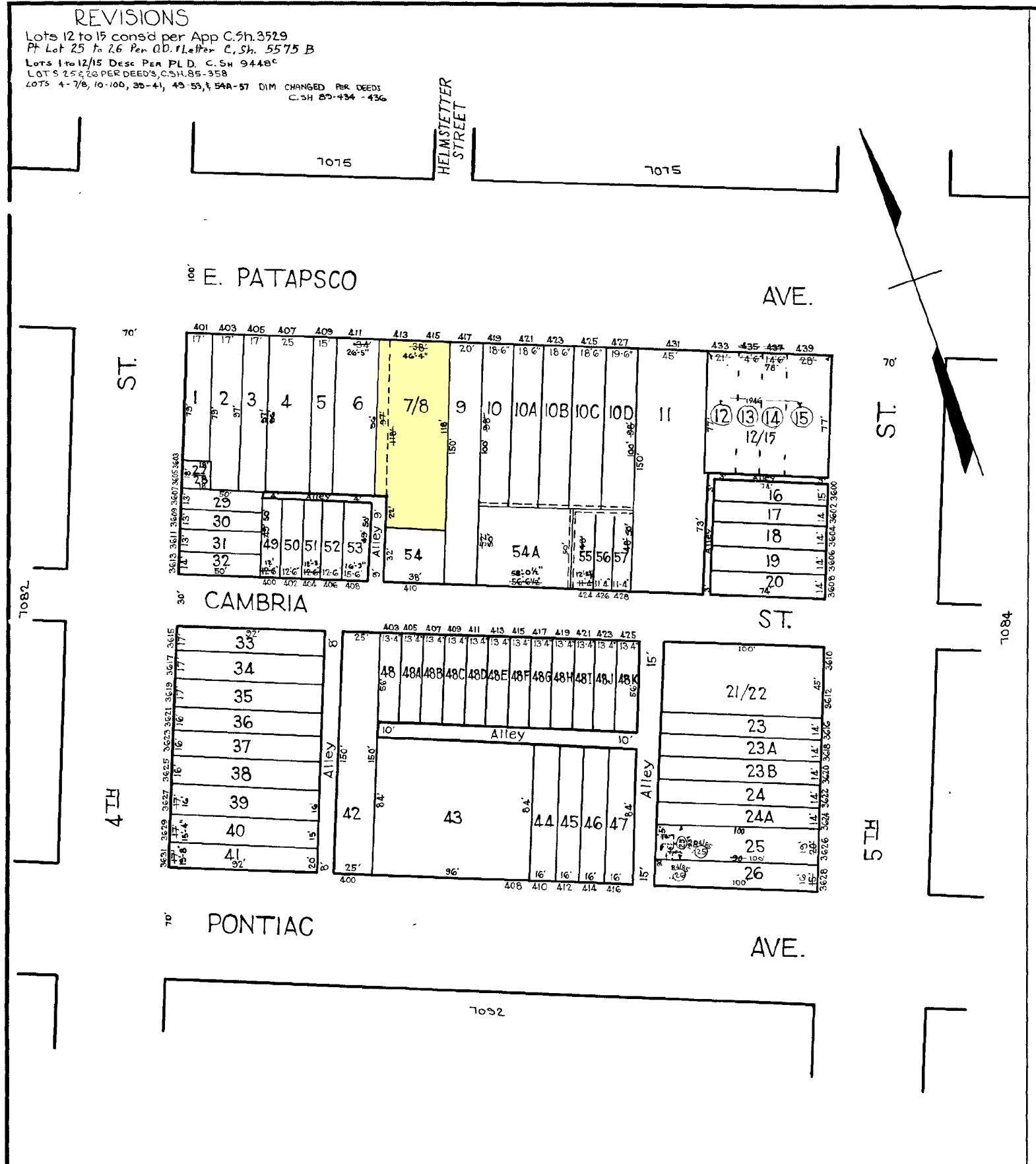

NOTICE

THIS IS A REAL PROPERTY PLAT AS PROVIDED
 FOR UNDER ARTICLE 76(h) OF THE CITY CHARTER.
 IT IS COMPILED FROM TITLE AND OTHER
 SOURCES AND IS NOT AN AUTHENTIC SURVEY

NOTE - BLOCK 25-G-55 FOR 1941

TRACED BY M.C. STUMPF

LETTERED BY J.J.R.

CHECKED BY

7083

CITY OF BALTIMORE
 DEPARTMENT OF PUBLIC WORKS
 BUREAU OF PLANS & SURVEYS
 PROPERTY LOCATION DIVISION

WARD 25 SECTION 6
 BLOCK 7083

SCALE 1/4" = 50 FT. DATE Dec. 1930