

PLAT NO. 3672

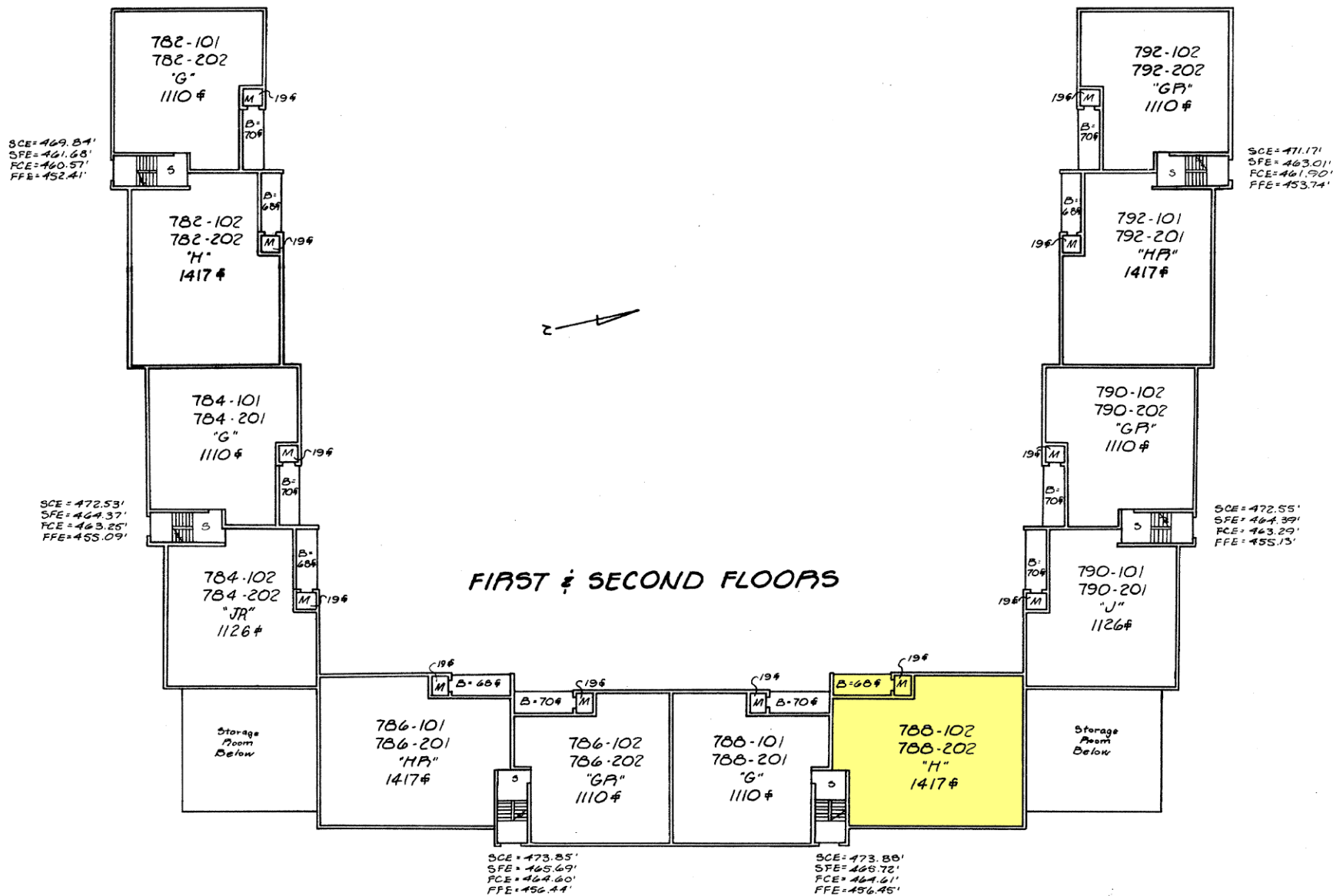

FIRST & SECOND FLOORS

LEGEND

G.C.E.: GENERAL COMMON ELEMENT
 L.C.E.: LIMITED COMMON ELEMENT
 B.: BALCONY (L.C.E.)
 L.: LAUNDRY ROOM (G.C.E.)
 P.: PATIO (L.C.E.)
 M.: MECHANICAL ROOM (L.C.E.)
 MR.: METER ROOM (G.C.E.)
 S.: STAIRS (G.C.E.)
 T.: TERRACE (L.C.E.)
 TR.: TRANSFORMER ROOM (G.C.E.)
 TS.: TENANT STORAGE (L.C.E.)
 PFE.: PATIO LEVEL FLOOR ELEVATION
 PCE.: PATIO LEVEL CEILING ELEVATION
 FFE.: FIRST FLOOR ELEVATION
 FCE.: FIRST FLOOR CEILING ELEVATION
 SFE.: SECOND FLOOR ELEVATION
 SCE.: SECOND FLOOR CEILING ELEVATION

GENERAL NOTES

UNITS ARE IDENTIFIED BY THEIR STREET ADDRESS AND A UNIT DESIGNATION WITHIN THE BUILDING, i.e. 762-201

THE LETTERS "E" THRU "K" REFER TO THE UNIT TYPE. WHEN THESE LETTERS ARE FOLLOWED BY A "R", THE UNIT IS A REVERSAL OF THE TYPE DESIGNATED. DIMENSIONED TYPICAL UNITS ARE SHOWN ON SHEET(S) 3 & 4 OF THIS SET OF CONDOMINIUM PLATS.

THE AREAS OF UNITS ARE MEASURED IN SQUARE FEET AND SHOWN AS FOLLOWS: 982#

THE FLOOR AND CEILING ELEVATIONS AND THE UNIT DIMENSIONS ARE MEASURED IN ACCORDANCE WITH THE APPLICABLE PROVISIONS OF THE DECLARATION OF DIAMOND FARMS CONDOMINIUM.

ELEVATIONS ARE REFERENCED TO THE WASHINGTON SUBURBAN SANITARY COMMISSION DATUM.

PLAT OF CONDOMINIUM
 DIAMOND FARMS CONDOMINIUM

BUILDING M

PHASE II-C

9th ELECTION DISTRICT
 MONTGOMERY COUNTY, MARYLAND
 Scale: 1" = 20' August, 1984

FILED
 SEP 21 1984

RECORDED:
 CONDOMINIUM
 PLAT BOOK:
 PLAT NO.:

S. Ruffin Maddox, Inc.
 7210 Exfair Road
 Bethesda, Maryland 20814
 (301) 656-3416

Maryland State Archives
 1
 2
 3
 4
 5
 6
 7
 8
 9
 10
 11
 12
 13
 14
 15
 16
 17
 18
 19
 20
 21
 22
 23
 24
 25
 26
 27
 28
 29
 30
 31
 32
 33
 34
 35
 36
 37
 38
 39
 40
 41
 42
 43
 44
 45
 46
 47
 48
 49
 50
 51
 52
 53
 54
 55
 56
 57
 58
 59
 60
 61
 62
 63
 64
 65
 66
 67
 68
 69
 70
 71
 72
 73
 74
 75
 76
 77
 78
 79
 80
 81
 82
 83
 84
 85
 86
 87
 88
 89
 90
 91
 92
 93
 94
 95
 96
 97
 98
 99
 100

MONTGOMERY COUNTY CIRCUIT COURT (Condominium Plats, MO) Plat 3672, MSA_S1264_494 Date availed 1984/09/21 Time 09:23:21