

REVISIONS

BLOCK REVISED 5-17-38 C. Sh. 1555 A/B.
 Lot 27 Divided Per Deed C. Sh. 4418.
 Lot 23 Div. Per Deed C. Sh. 922
 Lots 20 & 42 Per Deed C. Sh. 76-239.
 Lots 13, 38 & 39 Div. & Consd Per Deeds C. Sh. 86-093
 Lot 21 Per Deed C. Sh. 91-342
 Lots 1, 6, 34 & 37 Per Deed C. Sh. 92-260
 Lot 28 Div. & Consd into Lot 40 by Deed C. Sh. 03-172
 Lot 40 Address Added Per O.O.
 & P.L.S. C. Sh. 04-038 33

DELLWOOD AVE.

ROAD 6

UNION AVE.

FALLS

W. 37TH ST.

W. 38TH ST.

ST.

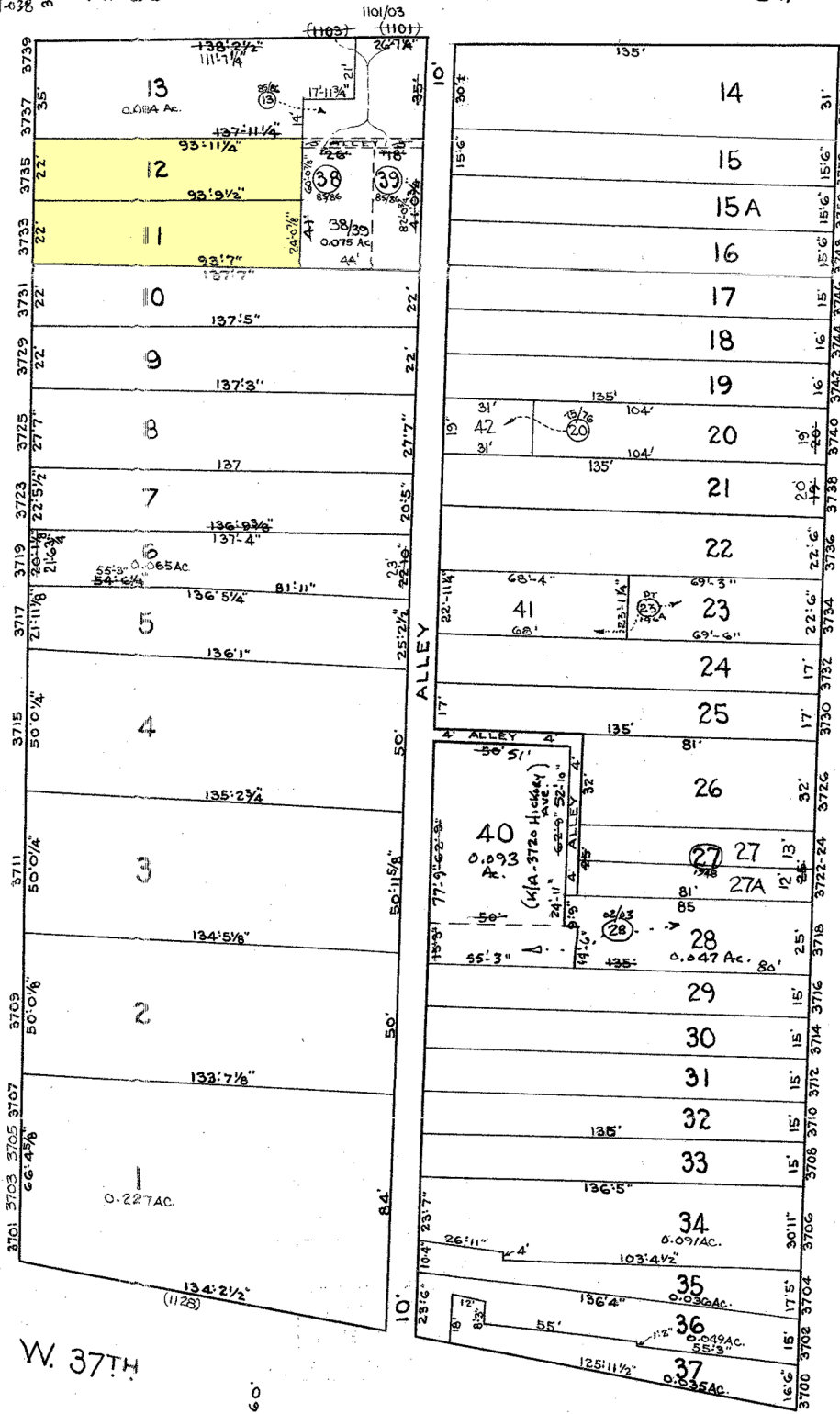

TRACED BY C.R. WARD
 LETTERED BY G.B.C. MILLER
 CHECKED BY _____

NOTICE
 THIS IS A REAL PROPERTY PLAT AS PROVIDED FOR UNDER ARTICLE 76(d) OF THE CITY CHARTER. IT IS COMPILED FROM TITLE AND OTHER SOURCES AND IS NOT AN AUTHENTIC SURVEY.

CITY OF BALTIMORE
 DEPARTMENT OF PUBLIC WORKS
 BUREAU OF PLANS & SURVEYS
 PROPERTY LOCATION DIVISION
WARD 13 SECTION 2
BLOCK 3552
 SCALE 1" = 40 FT. DATE MAY 1938.