

REVISIONS

Block Changed per B. of A. & P.S. C. Sh. 2937
 Lots 25A to 25L, 47A to 47C & 49 to 69 Par App. & BS. C.Shs 44704471
 Lot 57 HoNo. Per P.L.D., C. Sh. 5878B.
 Lot 69, Desc. Cor. Per D. of A.; C. Sh 1076D.

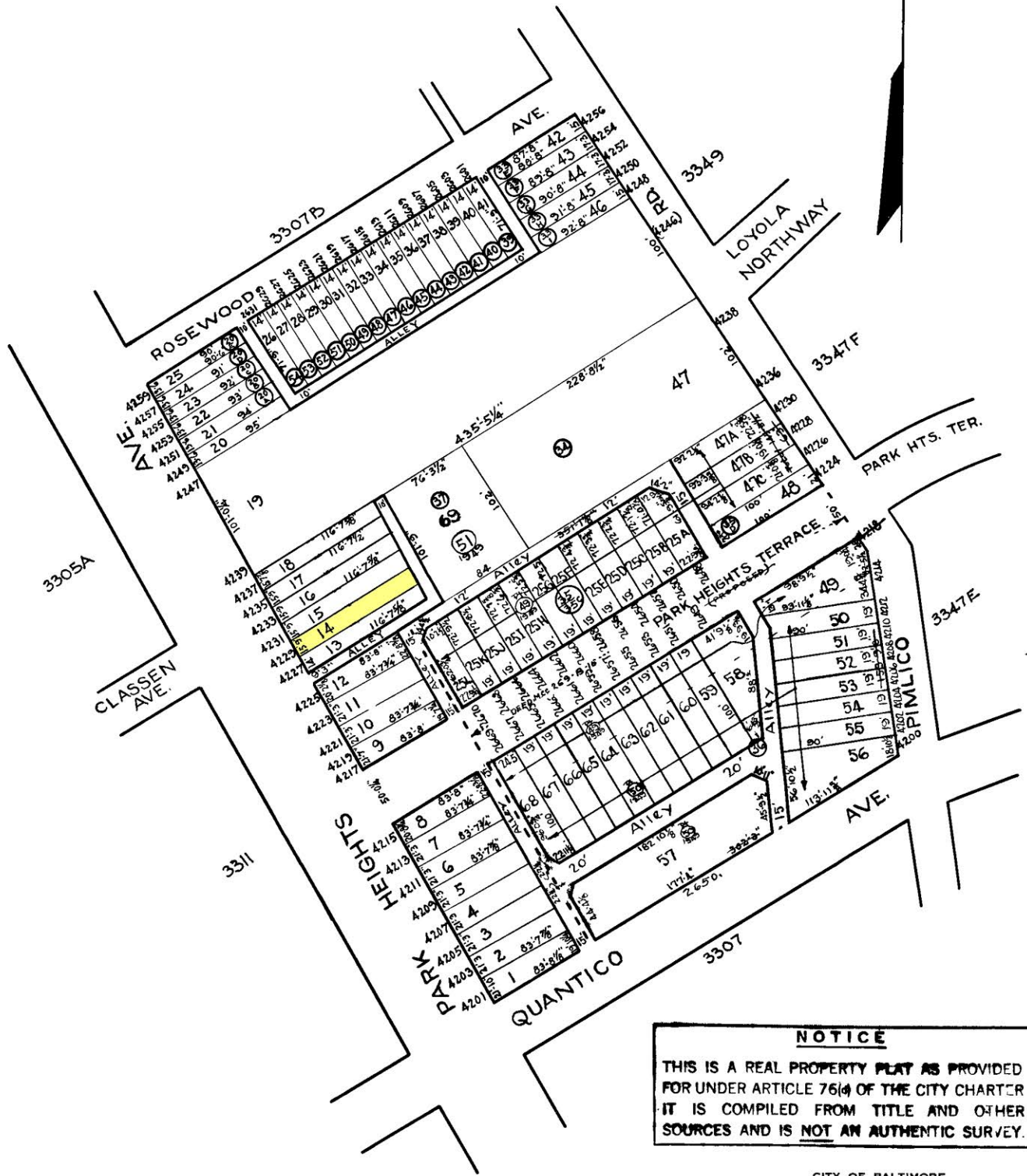

NOTE: (P) LOT NO BLOCK 15-19-3307A FOR 1943

TRACED BY G A Smith.
 LETTERED BY *R. Lutz*
 CHECKED BY

NOTICE
 THIS IS A REAL PROPERTY PLAT AS PROVIDED FOR UNDER ARTICLE 76(a) OF THE CITY CHARTER IT IS COMPILED FROM TITLE AND OTHER SOURCES AND IS NOT AN AUTHENTIC SURVEY.

CITY OF BALTIMORE
 DEPARTMENT OF PUBLIC WORKS
 BUREAU OF PLANS & SURVEYS
 PROPERTY LOCATION DIVISION

WARD 15 SECTION 34
 BLOCK 3307-A

SCALE 1/4" = 80 FT. DATE April 1943