

REVISIONS

LOTS 10 & 39 PER DEED, C.S.H. 90-240

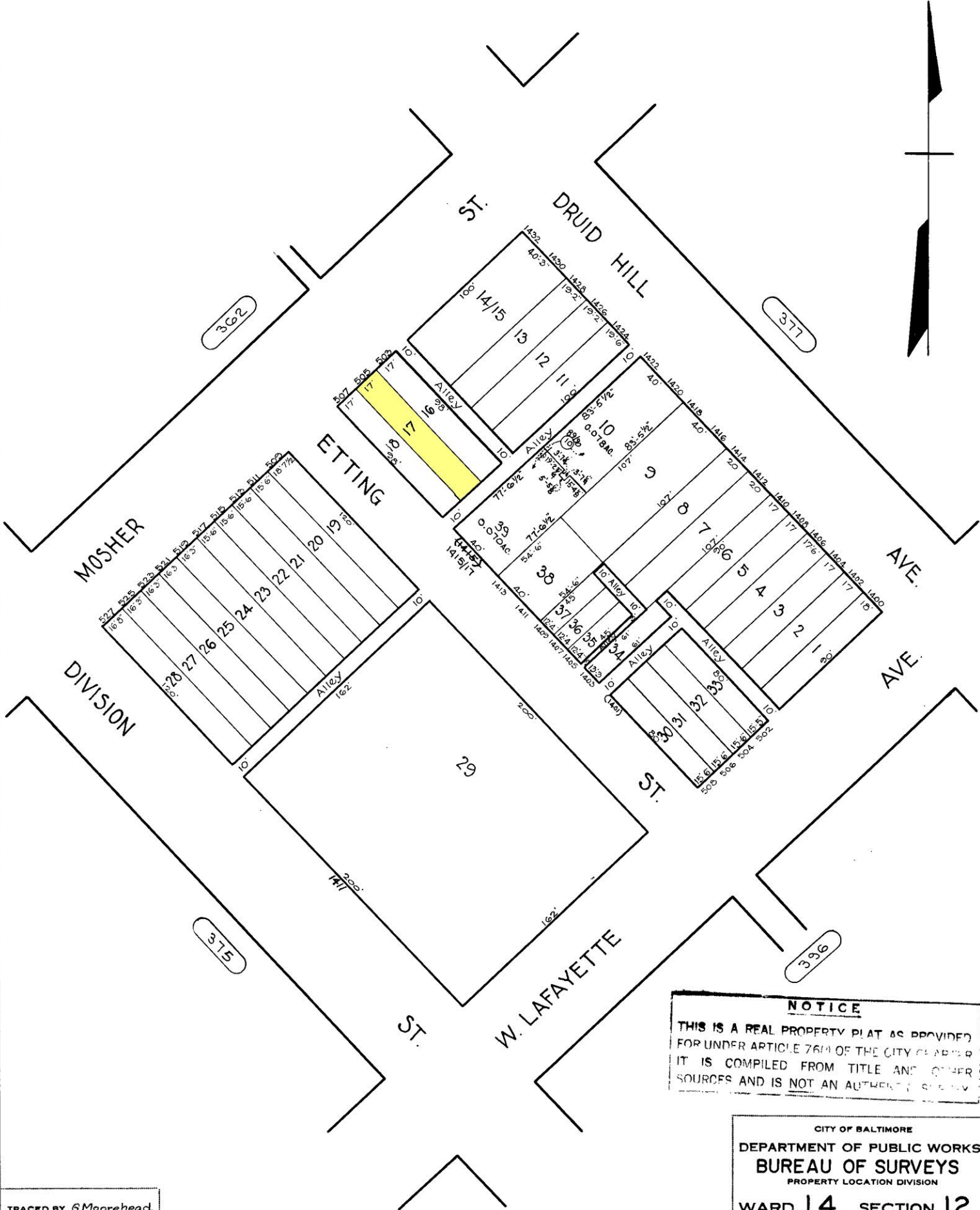
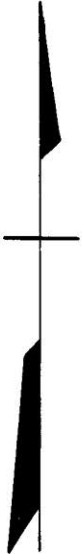

**NOTICE**  
THIS IS A REAL PROPERTY PLAT AS PROVIDED FOR UNDER ARTICLE 76A OF THE CITY CHARTER. IT IS COMPILED FROM TITLE AND OTHER SOURCES AND IS NOT AN AUTHENTIC COPY.

CITY OF BALTIMORE  
DEPARTMENT OF PUBLIC WORKS  
BUREAU OF SURVEYS  
PROPERTY LOCATION DIVISION

WARD 14 SECTION 12  
BLOCK 376

SCALE 1" = 50' 0" DATE June 1929

TRACED BY G. Moorehead  
LETTERED BY W.M. Lee  
CHECKED BY \_\_\_\_\_