

REVISIONS

LOTS 13C & 13D PER APP 344/47 C. SH 2244.
 LOTS 13C, 13D, 14/14A & 15 PER P.S & DEEDS C. SH (2995, Void) 3074.
 REAR PARTS LOTS 13A & 13B ABSORBED IN LOT 11 PER DEED C. SH. 3233
 LOT 13A & 13B CONVD PER APP. C. SH. 9576
 LOT 13 PER DEED, C. SH. 521
 LOT 11 DIV. PER DEED, C. SH. 36-194

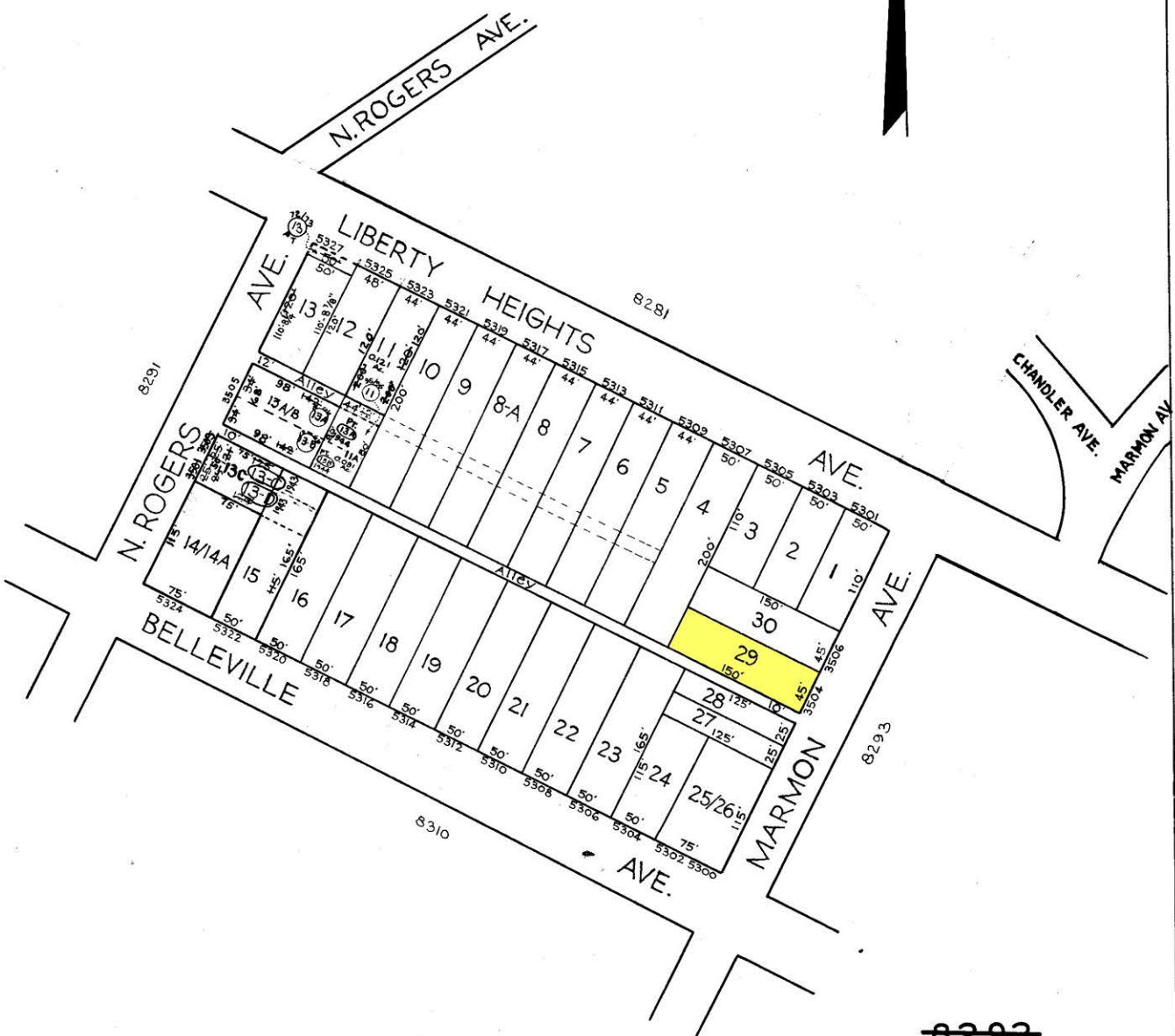

NOTICE
 THIS IS A REAL PROPERTY PLAT AS PROVIDED FOR UNDER ARTICLE 76(d) OF THE CITY CHARTER. IT IS COMPILED FROM TITLE AND OTHER SOURCES AND IS NOT AN AUTHENTIC SURVEY

NOTE: BLOCK 28-3-12 FOR 1941

TRACED BY... C. BAIN
 LETTERED BY J.J.R.
 CHECKED BY.....

8292
 CITY OF BALTIMORE
 DEPARTMENT OF PUBLIC WORKS
 BUREAU OF PLANS & SURVEYS
 PROPERTY LOCATION DIVISION
 WARD 28 SECTION 3
 BLOCK **8292**
 SCALE 1/4" = 100 FT. DATE Feb. 1932