

REVISIONS
 Lots 4, 4A per Deed O.O.C. Sh. 935
 Lots 5 & 6 Cons. O. Atty. Lovett C. Sh. No. 1104
 Lot 36 per Deed C. Sh. 7925

ORD. 1165 - 5-11-1950
 LEWIN AVE.

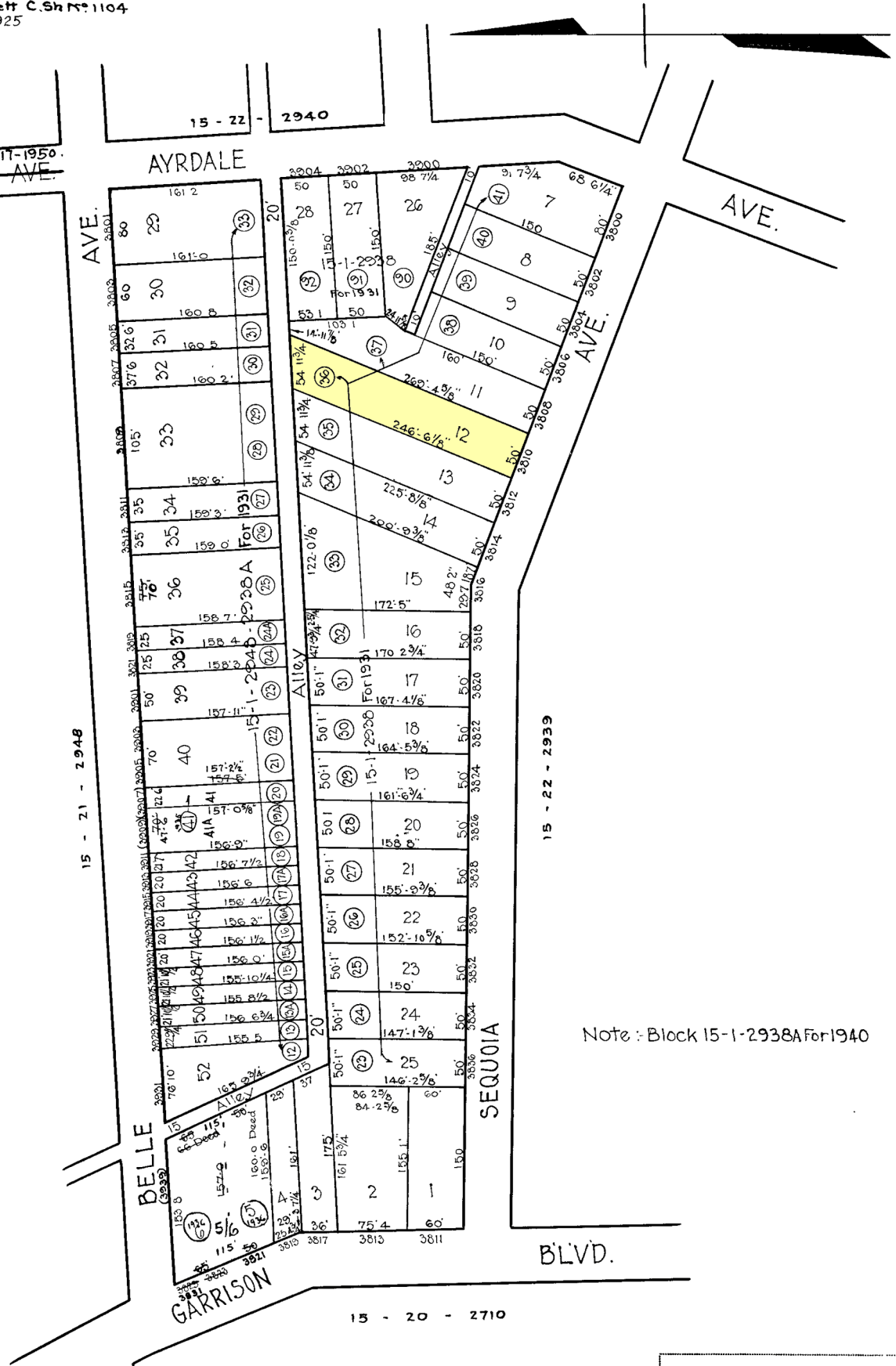

Note: Block 15-1-2938A For 1940

NOTICE
 THIS IS A REAL PROPERTY PLAT AS PROVIDED
 FOR UNDER ARTICLE 76(f) OF THE CITY CHARTER
 IT IS COMPILED FROM TITLE AND OTHER
 SOURCES AND IS NOT AN AUTHENTIC SURVEY

CITY OF BALTIMORE
 DEPARTMENT OF PUBLIC WORKS
 BUREAU OF PLANS & SURVEYS
 PROPERTY LOCATION DIVISION
WARD 15 SECTION 22
BLOCK 2938
 SCALE: 1" = 100' 0" DATE Jan. 1930.

TRACED BY L.S. Bell
 LETTERED BY W.M. Lee
 CHECKED BY