

SHOPPING CENTER

BENDIX AVIATION

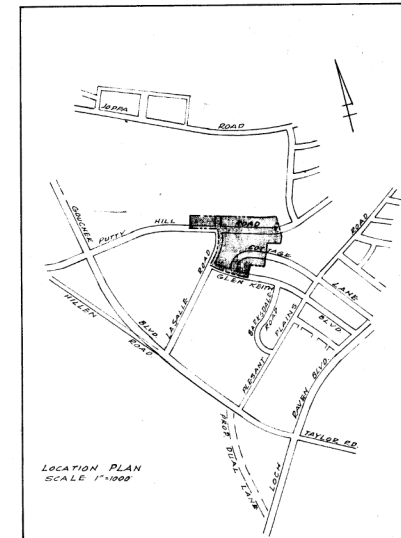

BALTIMORE COUNTY BOARD OF EDUCATION ELEMENTARY SCHOOL

NO.	EAD	Δ	ARC	TAN	CH	L.C.B.
1	1637.00	2° 30' 06"	71.48'	33.76'	71.42'	N 77° 18' 15" W
2	1597.00	3° 08' 21"	87.50'	43.36'	87.48'	N 77° 37' 20" W
3	825.00	21° 25' 21"	308.46'	156.35'	306.66'	S 36° 45' 50" E
4	845.00	18° 21' 00"	285.87'	144.06'	284.02'	S 35° 43' 40" E
5	540.72	9° 21' 51"	88.37'	44.28'	88.22'	N 12° 24' 28" W
6	536.72	5° 47' 00"	56.19'	28.12'	56.17'	N 14° 11' 54" W
7	960.00	21° 22' 54"	358.26'	181.24'	356.19'	S 36° 44' 38" E
8	1040.00	21° 58' 24"	392.33'	201.12'	394.80'	S 36° 59' 52" E
9	500.83'	29° 34' 37"	206.14'	106.55'	204.63'	N 25° 24' 18" E
10	535.83'	20° 18' 51"	209.21'	106.64'	206.91'	N 20° 28' 51" E
11	130.00	62° 15' 39"	141.27'	78.52'	134.42'	N 20° 38' 15" E
12	70.00	62° 15' 39"	76.07'	42.28'	72.38'	N 20° 38' 15" E
13	794.00	15° 25' 56"	213.86'	103.58'	213.21'	N 70° 30' 52" W
14	734.00	15° 25' 56"	197.70'	98.45'	197.10'	N 70° 30' 52" W
15	767.00	15° 50' 06"	210.32'	108.85'	208.65'	N 65° 49' 12" W
16	731.00	11° 41' 06"	149.05'	74.79'	148.80'	S 52° 5' 46" E

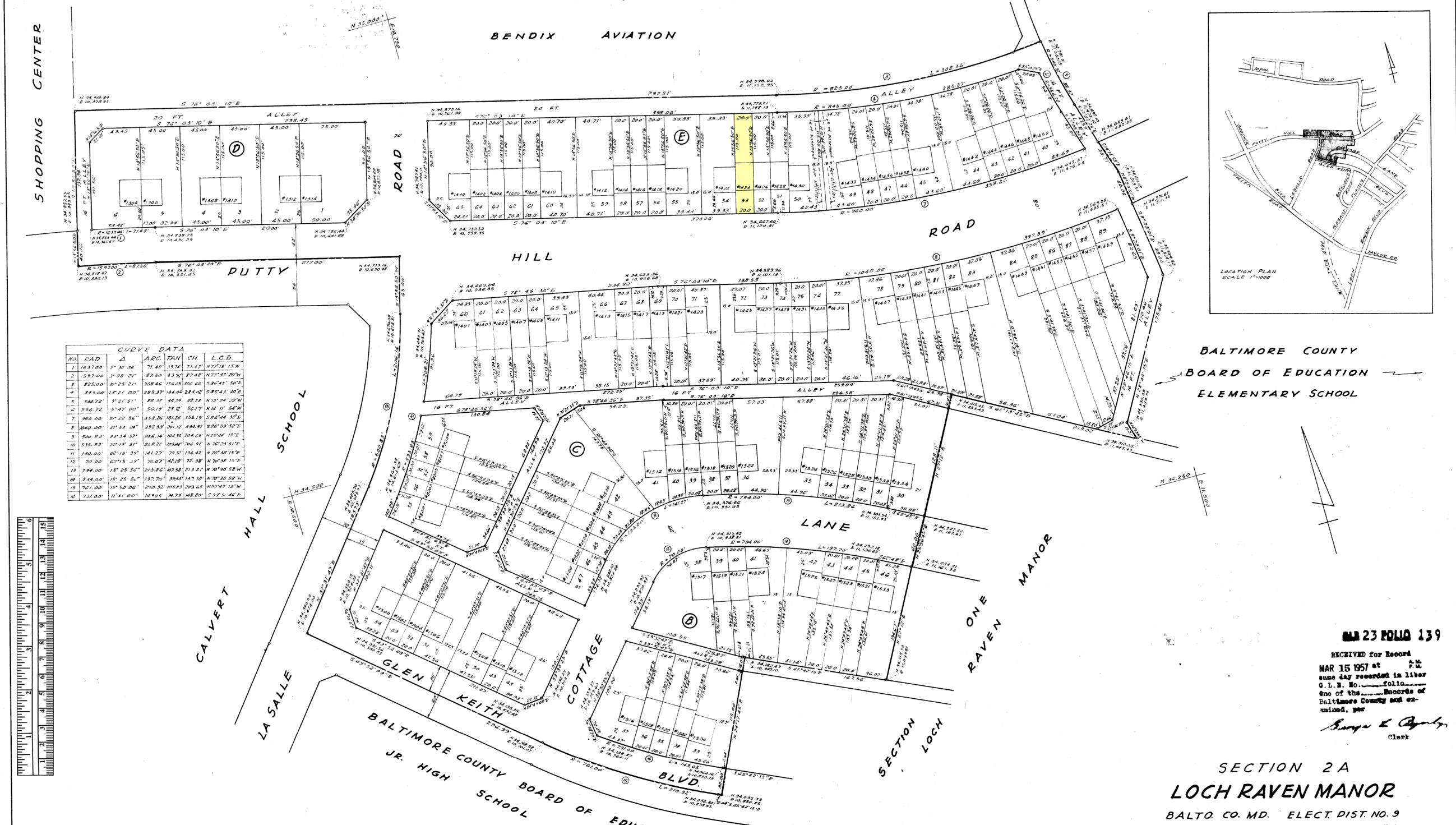

MA 23 POLIO 139  
 RECEIVED for Record  
 MAR 15 1957 at 4:11 PM  
 same day recorded in Liber  
 G.L.B. No. \_\_\_\_\_ folio  
 one of the \_\_\_\_\_ Records of  
 Baltimore County and ex-  
 amined, per  
*Surgeon & County*  
 Clerk

SECTION 2A  
**LOCH RAVEN MANOR**  
 BALTO. CO. MD. ELECT. DIST. NO. 9  
 SCALE 1"=50 FT. NOVEMBER 1956

SWARTHMORE CO. DEVELOPERS  
 8403 LOCH RAVEN BOULEVARD  
 BALTIMORE CO. MARYLAND

OWNERS CERTIFICATE  
 Certification is hereby made that all the require-  
 ments of the Annotated Code of Maryland Chap-  
 ter 1016 Acts of 1945 have been complied with on  
 this plat.  
 SWARTHMORE CO.  
*James Donment*  
 President

CERTIFICATION:  
 Certification is hereby made that this plat was  
 computed by G.W. Stephens Jr. & Associates Inc. and  
 that it meets the requirements of Section 72-B  
 Article 17 of the Annotated Code of Maryland 1947  
 Supplement.  
*John H. Stephens Jr.*  
 Reg. No. 200

NOTE:  
 The Streets and/or roads as shown hereon and  
 the mention thereof in deeds are for the purpose  
 of description, only and the same are not intended  
 to be dedicated to public use. The fee simple  
 title to the beds thereof is expressly reserved  
 in the grantors of the deed to which this plat  
 is attached, their heirs and assigns.

Approved as to alignment and location of Streets  
*Robert C. Stange*  
 Roads Engineer of Baltimore Co., Md.  
 Approved by Baltimore County Planning Board  
*Director*

Approved by Baltimore County Health Department  
*William H. J. Winters, M.D.*  
 Deputy State and County Health Officer

NOTE:  
 Coordinates are referred to Traverse of Baltimore  
 County Metropolitan District.

LEGEND  
 outline of Plat shown thus: \_\_\_\_\_  
 Boundary of Roads shown thus: \_\_\_\_\_  
 Lot lines shown thus: \_\_\_\_\_  
 Lot Nos. shown thus: 78  
 House Nos. shown thus: 1517  
 Block Nos. shown thus: ①  
 Easements for Utilities shown thus: - - - - -

BALTIMORE COUNTY CIRCUIT COURT (Subdivision Plats, BA) Plat Book GLB 23, p. 139, MSA, 51236-1646. Date available 1957/03/15. Printed 12/09/2021.