

REVISIONS

Lot 85 Corrected Per Deed & Field C. Sh 1522.
 Lot 101 Div Per Deed C. Sh 6186
 Lot 86/87 Per O.O. (Letter) C. Sh 8827
 Lots 66/67 Cons'd Per Deed, C. Sh 242
 Lot 64/67 Cons'd Per App. C. Sh. 80-183

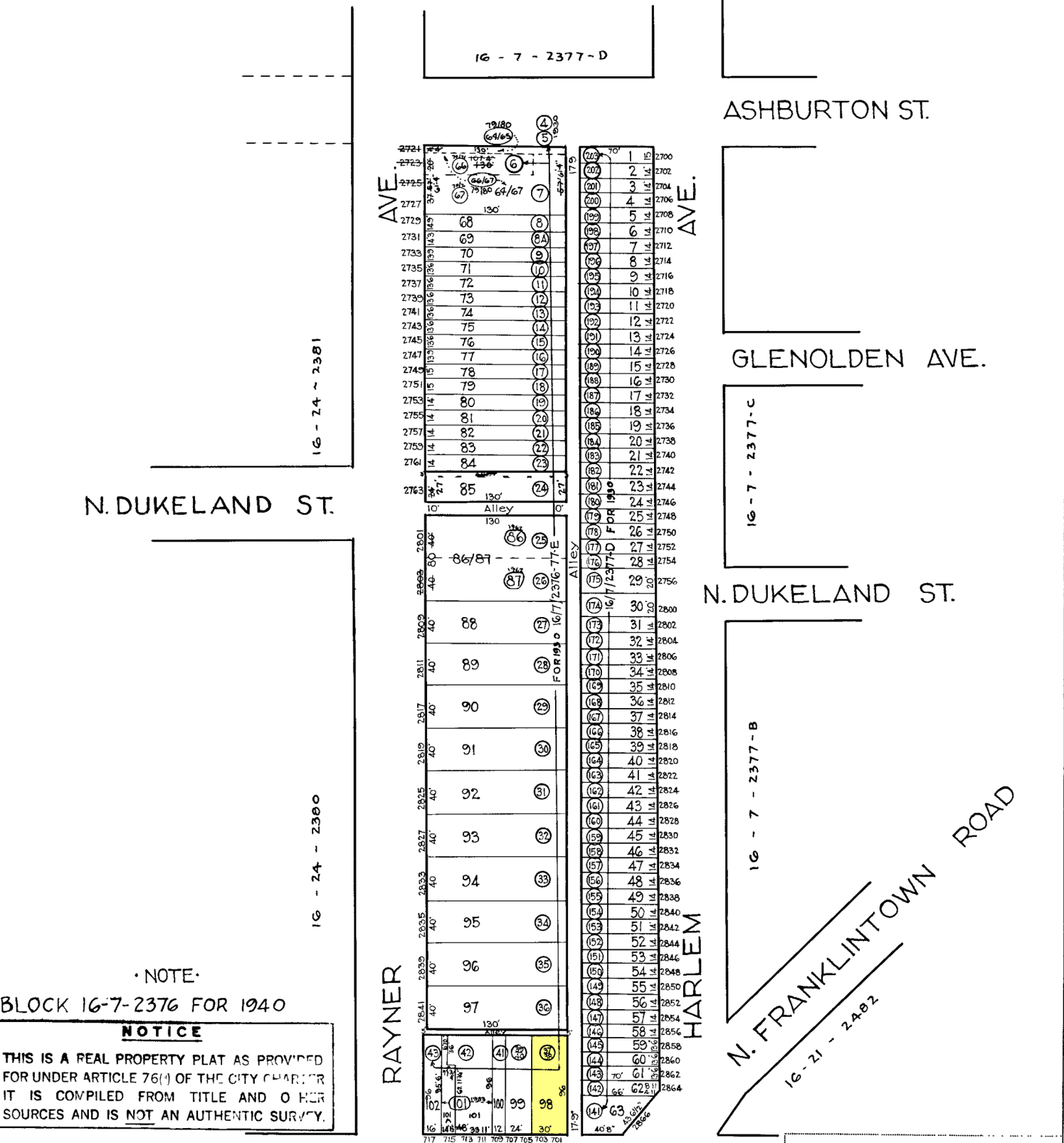
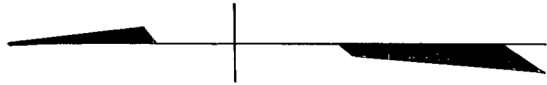

N. DUKELAND ST.

ASHBURTON ST.

GLENOLDEN AVE.

N. DUKELAND ST.

POPLAR GROVE ST.

N. FRANKLINTOWN ROAD

NOTE:
 BLOCK 16-7-2376 FOR 1940

NOTICE

THIS IS A REAL PROPERTY PLAT AS PROVIDED FOR UNDER ARTICLE 76(1) OF THE CITY CHARTER. IT IS COMPILED FROM TITLE AND OTHER SOURCES AND IS NOT AN AUTHENTIC SURVEY.

CITY OF BALTIMORE
 DEPARTMENT OF PUBLIC WORKS
 BUREAU OF PLANS & SURVEYS
 PROPERTY LOCATION DIVISION

WARD 16 SECTION 7
 BLOCK 2377A

SCALE: 1" = 80 FT. DATE Feb. 1930

TRACED BY J.H. Kilmore

LETTERED BY J.S. J. Rokosky

CHECKED BY...

16 - 21 - 2477

16 - 21 - 2481