

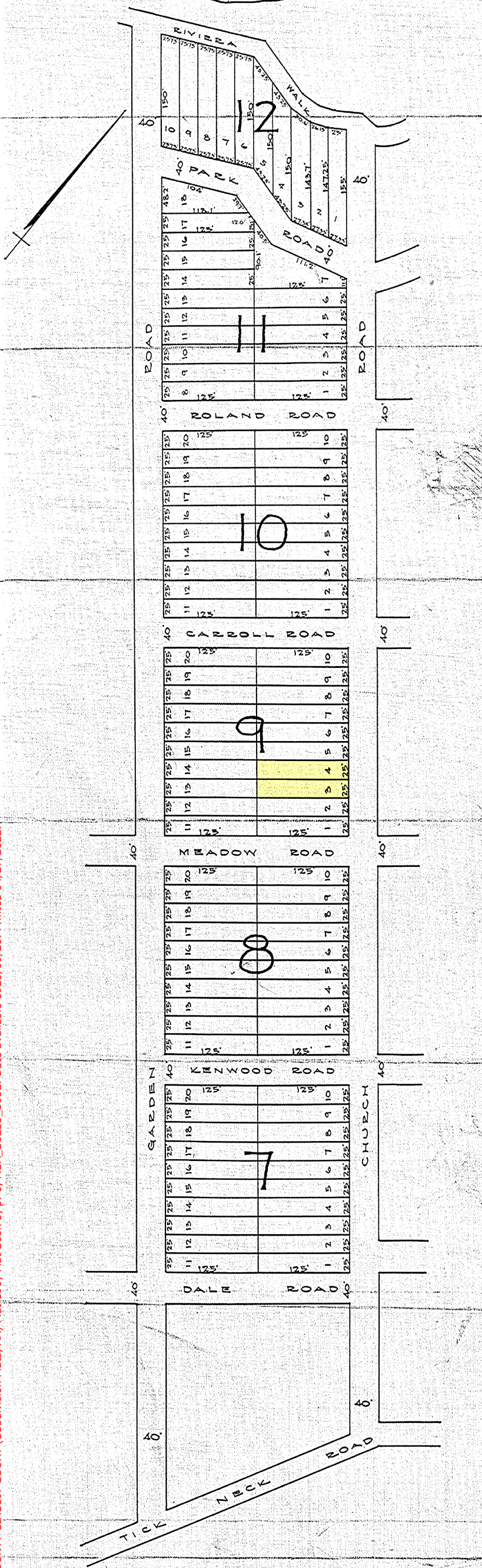

STONY CREEK



ANNE ARUNDEL COUNTY CIRCUIT COURT (Subdivision Plats, AA) Plat:190; Plat Book 5, p. 6, MSA_S1235_3052. Date available 1925/09/26. Printed 04/27/2022.

PLAT OF
PART OF
RIVIERA BEACH
AZALEA ARUNDEL COUNTY, MD.
RIVIERA BEACH DEVELOPMENT CO.
113 S. HANOVER ST.
BALTIMORE, MD.

SCALE 1"=100' SEPT 24 1925.
E. V. COONAN & CO.
SURVEYORS & CIVIL ENGRS.
231 COURTLAND ST.
BALTIMORE MD.