

NOTES

1. The subject property falls in flood zone "X" as shown on the flood hazard boundary map 24017C0485D dated 5/4/2015.
2. The licensee either personally prepared this drawing or was in responsible charge over its preparation and the surveying work reflected in it, all in compliance with requirements set forth in Regulation .12 of Chapter 06 Minimum Standards of Practice.
3. This plat was prepared without the benefit of a title report which may show additional conveyances, easements, covenants, or rights-of-way.
4. The source of data, bearings, and/or coordinates used on this drawing are based on the datum referenced : NAD 83

TAX MAP 83
PARCEL 17
VIRGINIA W. MEYER +
SUSAN W. GILMAN
DEED 11273-154
PB 61-169

TAX MAP 80
PARCEL 12
STATE OF
MARYLAND
DEED 6713-483
SECOND PARCEL

TAX MAP 83
PARCEL O
DEED 10786-188
HCC 24-G54
68,043 SQ.FT.*
1.562 AC.*

TAX MAP 80
PARCEL 13
YATTEN FARM LLC
DEED 8624-14
SECOND PARCEL

TAX MAP 80
PARCEL 12
STATE OF
MARYLAND
DEED 6713-483
SECOND PARCEL

TAX MAP 80
PARCEL 12
STATE OF MARYLAND
DEED 6713-483
FIRST PARCEL

WEST HATTON ROAD
30' RIGHT-OF-WAY

I hereby certify to the best of my professional knowledge and belief, that the property shown hereon has been accurately surveyed by a total-station survey (subject to title search), and that the improvements shown hereon, have been accurately located.

GEORGE A. PARRISH IV PROP. L.S. #577 12/28/2020
LICENSE EXPIRATION DATE: 3/24/2021

12991 WEST HATTON ROAD DEED 10786-188

BOUNDARY SURVEY AND LOCATION DRAWING
TAX MAP 83 PARCEL O

EFFECT INC. PROPERTY

FIFTH DISTRICT CHARLES COUNTY, MARYLAND

SCALE: 1" = 100' JANUARY 2021

FILE #CH10885 PROJECT #60978

CAD FILENAME: EFFECT-12991WESTHATTON

DRAWN BY: JMS CHECKED BY:

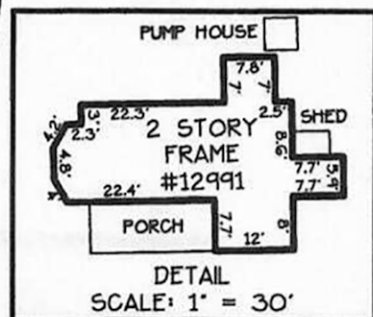

PO Box 880

Chesapeake Beach, Maryland 20732

Ph: 410-286-9712 Fax: 410-286-9716

Email: info@advancedsurveysinc.com