

NO.	RAD.	Δ	ARC. TAN.	CH.	L.C.B.
1	295.00	20°44'25"	112.08	53.35	116.32
2	385.00	33°26'15"	224.68	116.44	201.51
3	970.00	1°45'40"	29.82	16.41	29.81
4	1030.00	1°25'10"	25.52	12.76	25.82
5	348.63	31°40'35"	168.20	160.27	162.26
6	308.63	28°08'11"	146.23	141.77	143.71
7	303.00	28°44'25"	126.26	60.83	127.47
8	283.00	27°44'25"	96.44	48.87	97.93
9	435.46	14°10'57"	107.79	54.17	107.82
10	495.46	14°15'35"	123.30	61.98	122.98
11	3009.48	1°08'33"	60.00	36.00	60.00
12	1033.67	24°41'00"	447.93	244.48	447.93

GLB 24 POLD 59
 RECEIVED for Record
 AUG 14 1957
 same day recorded in liber
 G.L.B. No. _____
 One of the _____ Records of
 Baltimore County and sur-
 roundings, Md.
George S. Clark
 Clerk

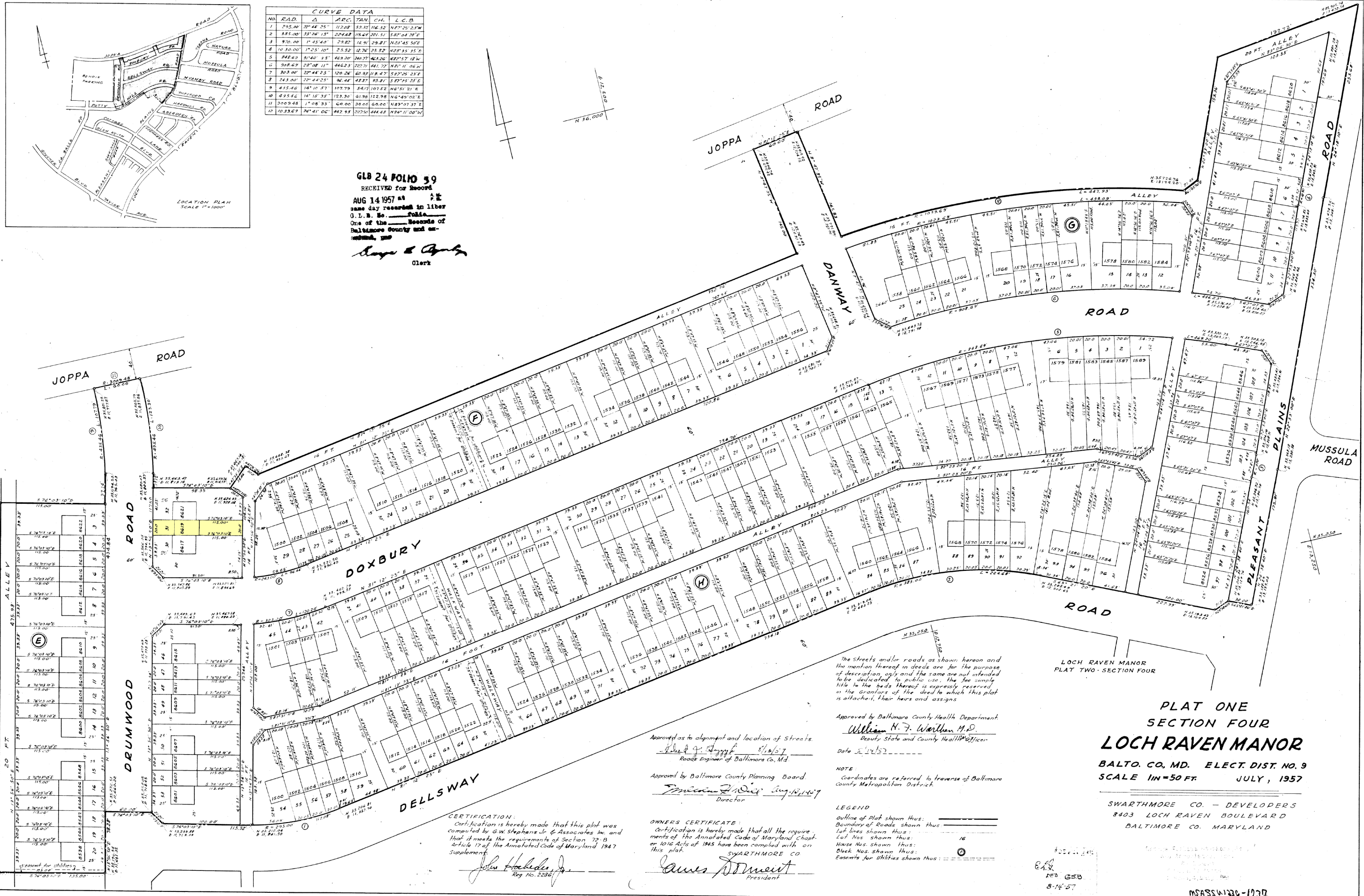

The streets and/or roads as shown hereon and the mention thereof in deeds are for the purpose of description only and the same are not intended to be dedicated to public use, the fee simple title to the beds thereof is expressly reserved in the grantors of the deed to which this plat is attached, their heirs and assigns.

Approved by Baltimore County Health Department.
William H. F. Worthen, M.D.
 Deputy State and County Health Officer
 Date 8/14/57

NOTE:
 Coordinates are referred to traverse of Baltimore County Metropolitan District.

LEGEND
 Outline of Plat shown thus: _____
 Boundary of Roads shown thus: _____
 Lot lines shown thus: _____
 Lot Nos. shown thus: _____
 House Nos. shown thus: _____
 Easements for Utilities shown thus: _____

Approved as to alignment and location of Streets.
Edward J. Haggerty 8/13/57
 Roads Engineer of Baltimore Co., Md.

Approved by Baltimore County Planning Board.
Frederic J. Dier August 14, 1957
 Director

CERTIFICATION:
 Certification is hereby made that this plat was compiled by G.W. Stephens & Associates Inc. and that it meets the requirements of Section 72-B Article 17 of the Annotated Code of Maryland 1947 Supplement.
John Hebel, Jr.
 Reg. No. 2286

OWNERS CERTIFICATE:
 Certification is hereby made that all the requirements of the Annotated Code of Maryland Chapter 101a Acts of 1945 have been complied with on this plat.
 SWARTHMORE CO
James Torment
 President

LOCH RAVEN MANOR
 PLAT TWO - SECTION FOUR

PLAT ONE
 SECTION FOUR
LOCH RAVEN MANOR
 BALTO. CO., MD. ELECT. DIST. NO. 9
 SCALE 1 IN = 50 FT. JULY, 1957

SWARTHMORE CO. - DEVELOPERS
 8403 LOCH RAVEN BOULEVARD
 BALTIMORE CO. MARYLAND

8-14-57

GLB 24 POLD 59