

NO.	LATITUDE	DEPARTURE
1	443.23	1329.10
2	462.99	1214.93
3	463.92	1205.01
4	505.35	956.54
5	577.64	608.41
6	700.59	616.65
7	716.59	617.72
8	816.59	624.41
9	846.34	626.41
10	1013.97	686.31
11	984.17	1355.40
12	815.71	1547.21
13	785.74	1345.75
14	790.62	1230.85
15	791.05	1220.86
16	691.74	1216.61
17	675.21	1213.99
18	826.46	1094.14
19	925.45	1102.36
20	995.37	1093.37
21	1143.50	1092.86
22	996.96	686.58

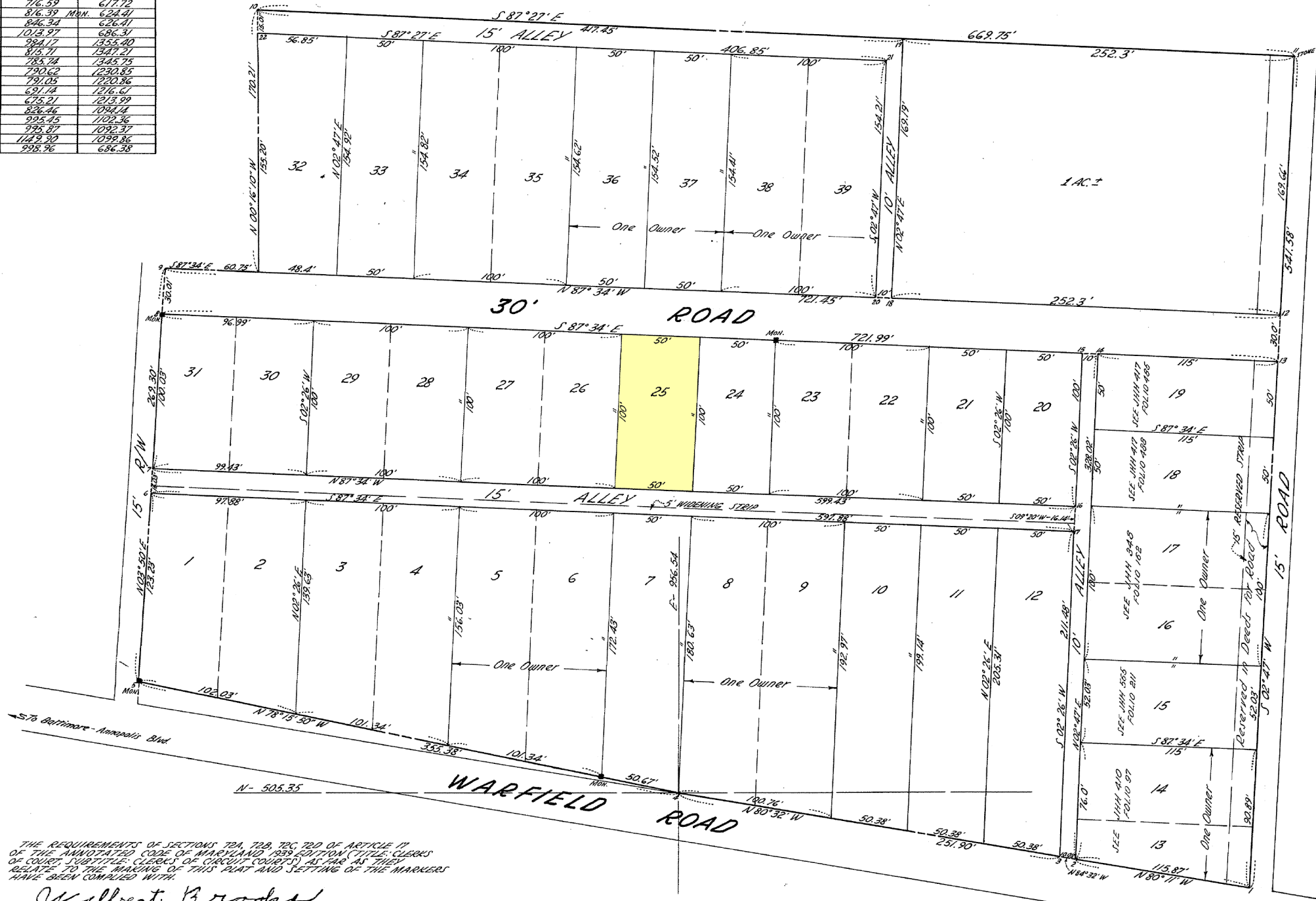

THE REQUIREMENTS OF SECTIONS 22A, 22B, 22C, 22D OF ARTICLE 17 OF THE ANNE ARUNDEL COUNTY CODE OF MICHIGAN 1959 EDITION (TITLE, CLERKS OF COURT, JUDGES, CLERKS OF CIRCUIT COURTS) AS FAR AS THEY RELATE TO THE MAKING OF THIS PLAT AND SETTING OF THE MARKERS HAVE BEEN COMPLIED WITH.

W. Albert Brooks
OWNER OF LAND SHOWN HEREON

John J. Latham
SURVEYOR CERTIFICATION

THE REQUIREMENTS OF THE ANNE ARUNDEL COUNTY HEALTH DEPT. HAVE BEEN MET IN PREPARING THIS PLAT. APPLICABLE FOR LEGAL PURPOSES ONLY. PUBLIC WATER TO BE EXTENDED AND USED AND DEEP PIT FOR MANURE STORAGE BUILDING.

J. Howard Beard 5/31/56
HEALTH OFFICER

APPROVED FOR RECORDING BY VIRTUE OF A SPECIAL EXCEPTION GRANTED BY THE PLANNING AND ZONING COMMISSION ORIGINALLY 7-6-56 AND CONFIRMED 10-3-57.

P. E. von Schwerdtner 8 Oct 57
PLANNING ADMINISTRATOR

We hereby dedicate to public use, for a road when needed by the County Roads Department, the 15' strip across lots 13 thru 19 as shown.

- LOTS 13 & 14 Kirklyn Dillard JHH 410-97
- LOT 15 Marie Johnston JHH 385-811
- LOTS 16 & 17 Ether Kenner JHH 416-545
- LOT 18 William R. Carter JHH 104-466
- LOT 19 Sarah Carter JHH 710-486

BROOKLYN TERRACE
NEAR BROOKLYN 5TH DIST. A. A. CO, MD

Scale: 1" = 50'

J. R. McCrane Jr., Inc.
Reg. Professional Engrs. & Land Surveyors
Annapolis, Md.

Dec. 30, 1955
NOTE: Originally laid out and described Sept 1944

FILED
1957 OCT 24 PM 10:53

1505

ANNE ARUNDEL COUNTY CIRCUIT COURT (Subdivision Plats, AA) Plat 1505, Plat Book 30, p. 30, MS A-S1235-3475, Date available 1957/10/24, Printed 12/14/2021.