

COUNTY

ROAD

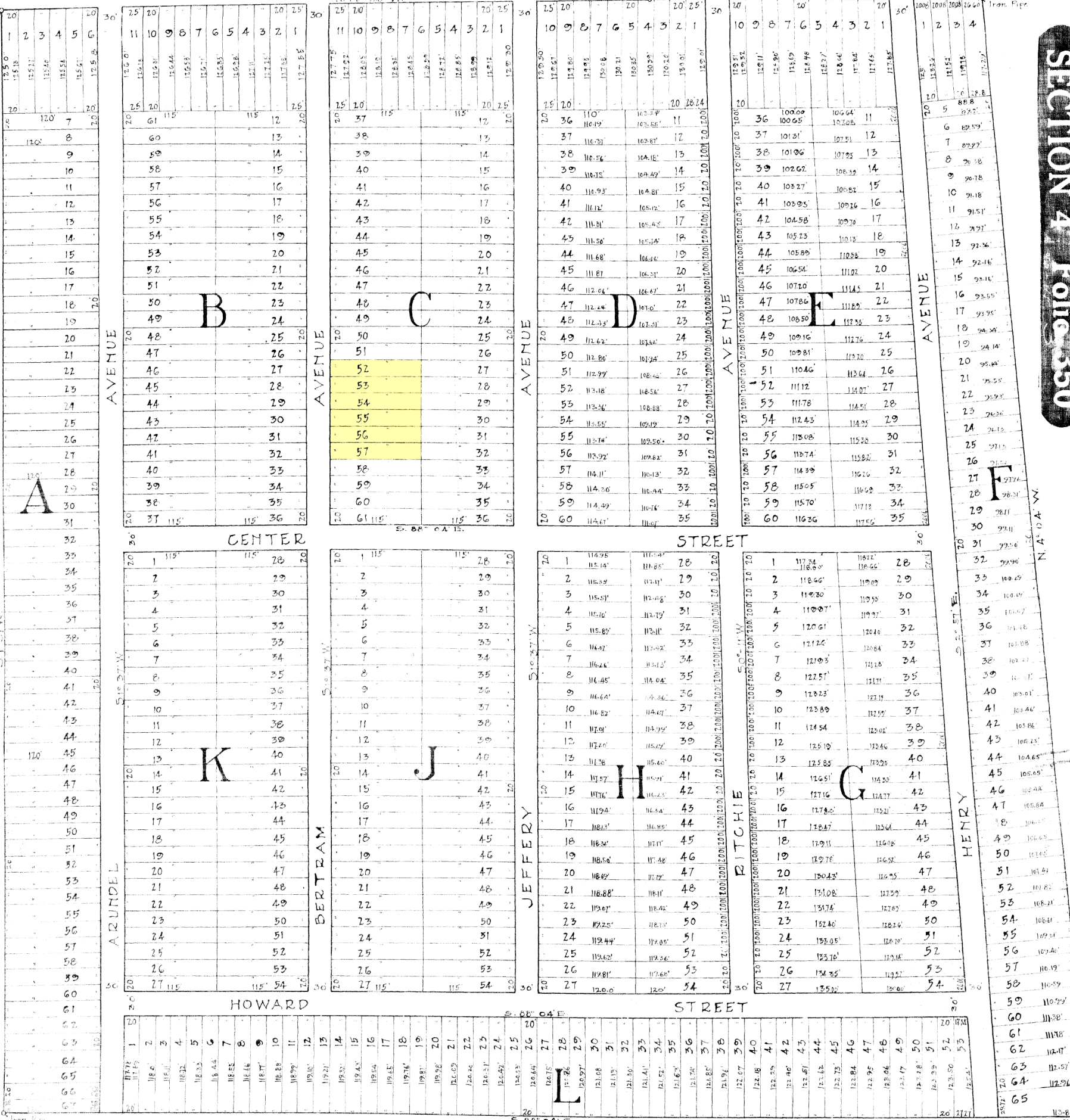

SECTION 4 Folio 350

# ARUNDEL MANOR

OWNED & CONTROLLED BY

THE UNITED REALTY & HOME BUILDERS CORP.

205 W. LOMBARD STREET BALTIMORE, MD.

SURVEYED & LAID OUT BY

J. SPENCE HOWARD

CIVIL ENGINEER BALTIMORE, MD. SCALE 1" = 60' MAY, 1922.

Block # 147-157 of 355

ANNE ARUNDEL COUNTY CIRCUIT COURT (Pat. Book, Overseer Copy Plat Book 15, p. 3, Plat B-155, MSA C2322, 852, Date available, Printed 06/27/2022)