

REVISIONS

Lots 23 & 24 Cons'd Per App 2373 C. SH 4064
 Lot 14 & 15 Cons'd Per App C. SH 5669
 Lots 16 to 22 dam corr per Deed & PLD C SH 6887 A
 Lots 40 & 41, 42 Cons'd Per O.O C. SH 9483
 Lots 1-11 & 13-15 Cons'd Per O.O., DEED & D.P. C. SH. 9571
 Lots 38, 39 & 40/42 Cons'd Per App. C. SH. 103
 Lot 23/25 Cons'd Per App. C. SH. 77-230
 Lot 23/25 Div Per Deed C. SH 78-026
 Lots 43-51 Cons'd & Div Per D.P & App. C. SH. 94-226
 Lots 38/42, 42A-42G Per Sub-Div & P.L.S. C. SH. 95-007

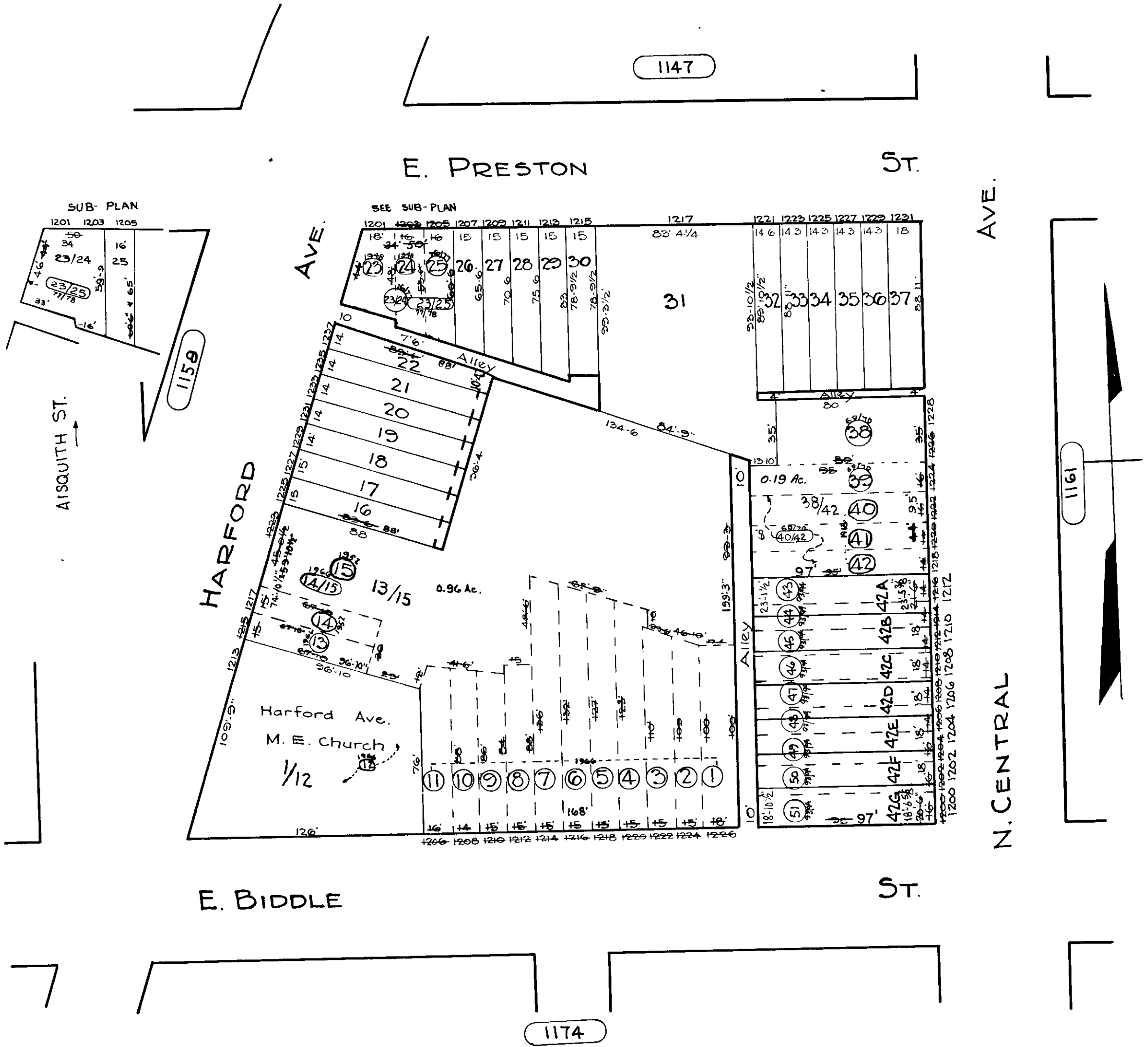

NOTICE

THIS IS A REAL PROPERTY PLAT AS PROVIDED FOR UNDER ARTICLE 76(a) OF THE CITY CHARTER IT IS COMPILED FROM TITLE AND OTHER SOURCES AND IS NOT AN AUTHENTIC SURVEY

TRACED BY...C. H. BAIN...

LETTERED BY...W. M. Lee...

CHECKED BY...W. M. Lee...
 R. LITZ - G. J. M.

CITY OF BALTIMORE
 DEPARTMENT OF PUBLIC WORKS
 BUREAU OF PLANS & SURVEYS
 PROPERTY LOCATION DIVISION
 WARD 10 SECTION 1
 BLOCK 1160
 SCALE 1" = 50'-0" DATE May 1929