

*** REVISIONS ***
 Lots 26, 76, 74 Corrected for 1936 (Field) Sh. 881
 " 27, 75, 73 " " 1936 " 917
 " 48, 49, 60, 61 per Field Deeds " 1353.
 " 11/12 per App. 1275 (1931) " C 57 1381.
 Lots 14, 7 Per Deed C Sh. 4668
 Lots 54, 6 Const. Per App. C Sh. 5674 Void
 Lots 3, 4, 6 Per O. O. 9 B. of A. C. Sh. 5893

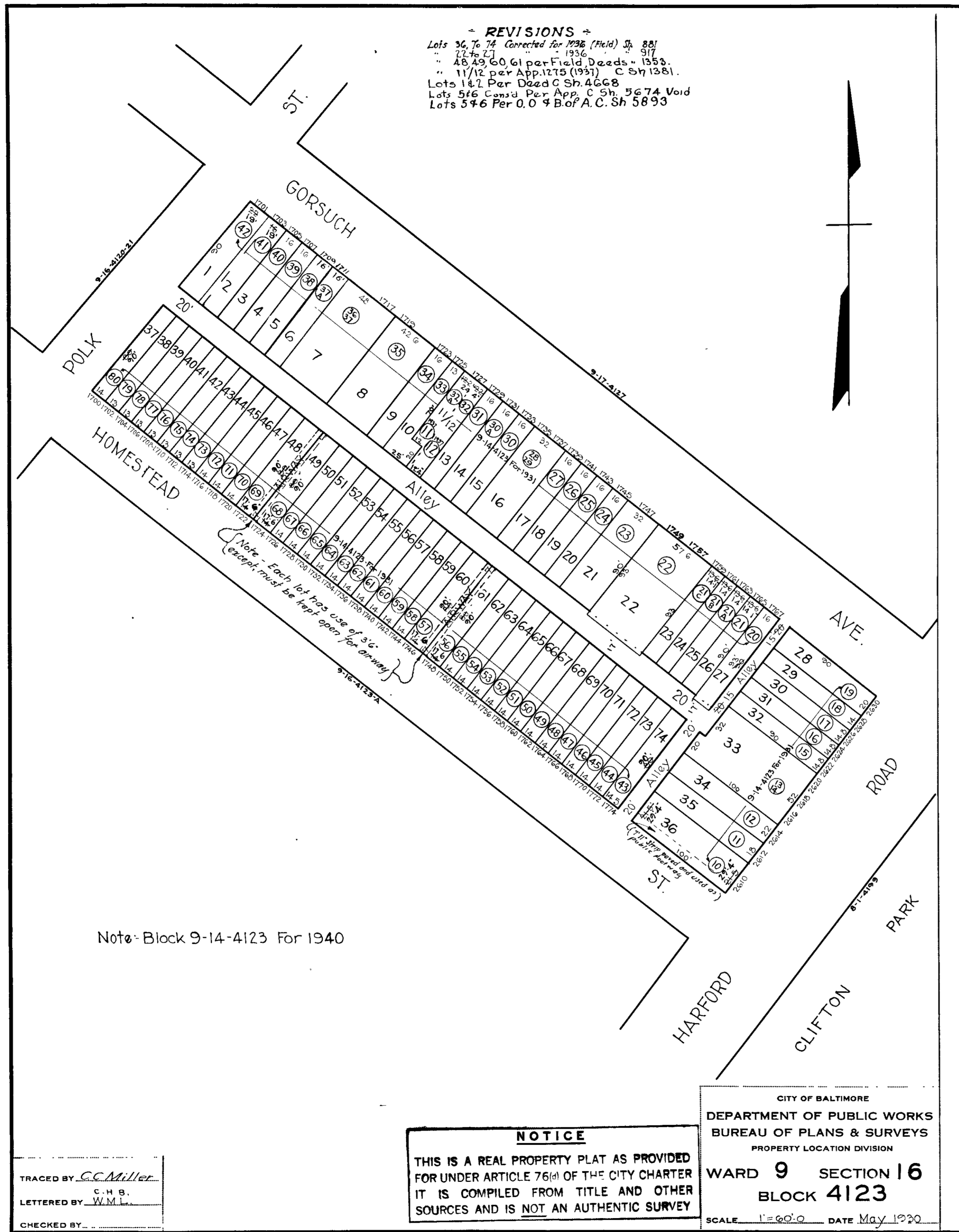

Note - Each lot has use of 3' 6"
 (except must be kept open for driveway)

Note - Block 9-14-4123 For 1940

TRACED BY C.C. Miller
 C. H. B.
 LETTERED BY W.M.L.
 CHECKED BY _____

NOTICE
 THIS IS A REAL PROPERTY PLAT AS PROVIDED
 FOR UNDER ARTICLE 76(d) OF THE CITY CHARTER
 IT IS COMPILED FROM TITLE AND OTHER
 SOURCES AND IS NOT AN AUTHENTIC SURVEY

CITY OF BALTIMORE
 DEPARTMENT OF PUBLIC WORKS
 BUREAU OF PLANS & SURVEYS
 PROPERTY LOCATION DIVISION
WARD 9 SECTION 16
BLOCK 4123
 SCALE 1"=600.0 DATE May 1930