

REVISIONS:
 LOTS 21 TO 24 CONS'D. PER. APP. C.S.H. 9840.

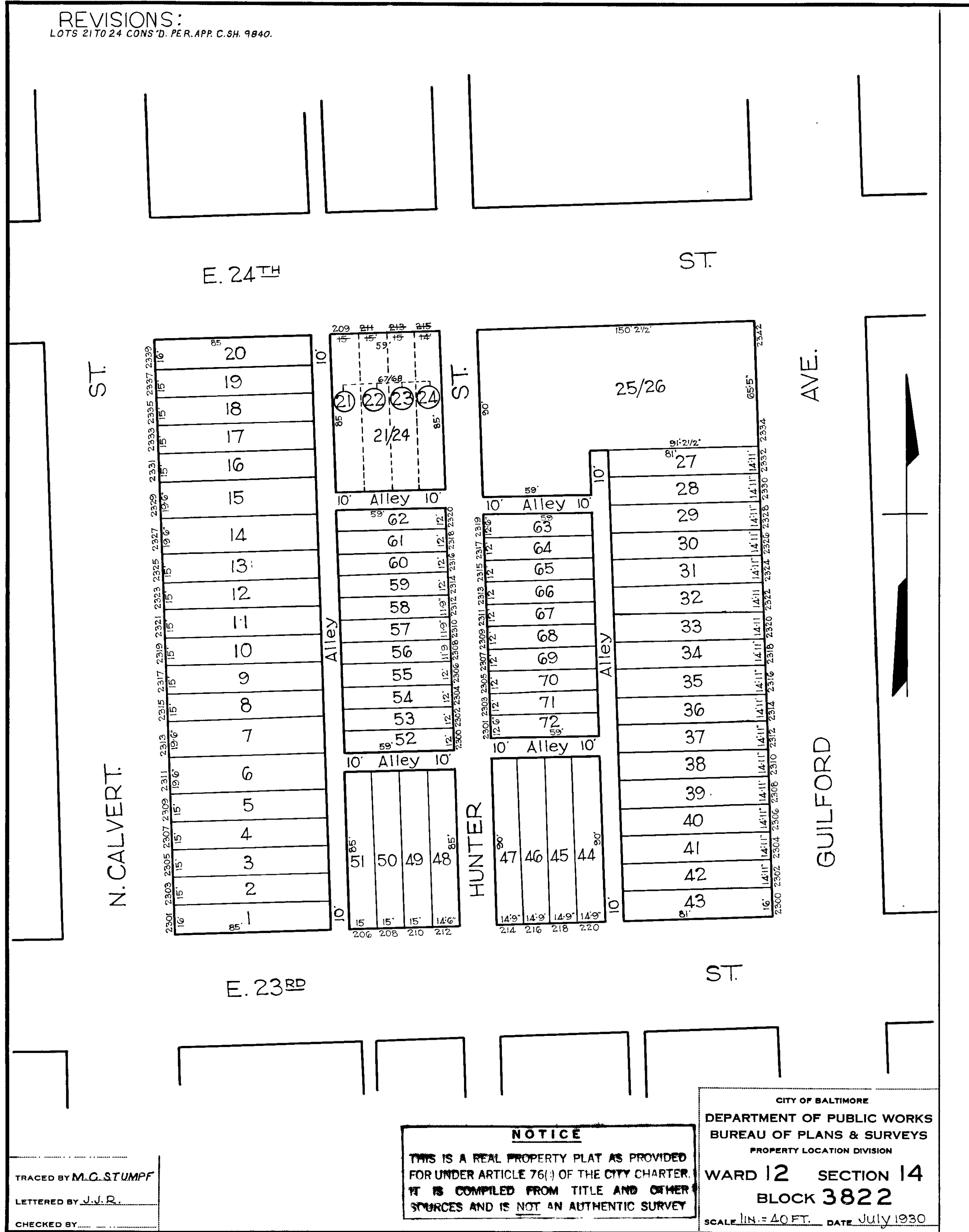

TRACED BY M.C. STUMPF
 LETTERED BY J.J.D.
 CHECKED BY _____

NOTICE
 THIS IS A REAL PROPERTY PLAT AS PROVIDED
 FOR UNDER ARTICLE 76(3) OF THE CITY CHARTER.
 IT IS COMPILED FROM TITLE AND OTHER
 SOURCES AND IS NOT AN AUTHENTIC SURVEY

CITY OF BALTIMORE
 DEPARTMENT OF PUBLIC WORKS
 BUREAU OF PLANS & SURVEYS
 PROPERTY LOCATION DIVISION
 WARD 12 SECTION 14
 BLOCK 3822
 SCALE 1/4" = 40 FT. DATE July 1930